



QUALITY DRYWALL PRODUCTS

**ALWAYS RELIABLE.
ALWAYS THE RIGHT CHOICE.**

Whatever your application, Speedline can provide the right materials to complete the job.

- **Access Panels**
- **Beading & Trims**
- **Fixings**
- **Sealants & Adhesives**
- **Jointing Accessories**
- **Metal Systems**
 - Partitioning Systems
 - Wall Lining Systems
 - Ceilings
 - Channels & Angles



DRY LINING PRODUCTS



Page No.

PLASTERBOARDS	4-7
Standard Boards	4
Performance Boards	4-5
Thermal Laminates	5-6
Specialist Boards	6-7
FINISHING PRODUCTS	8-9
PLASTERS & PLASTER ACCESSORIES	10
METAL PRODUCTS	11-16



Page No.

METAL COMPONENTS	32-34
ALUMINIUM TRIMS & MESH	35
UPVC BEADS	36
FIXINGS	38-39
JOINTING PRODUCTS	40
SEALANTS & ADHESIVES	41
ACCESSORIES	42
Speedline Acoustic Firecaps	42
Speedline Putty Pads	42
Speedline Chipboard	42
Speedline Protection Board	42
Speedline Thermal Laminate Plasterboard	42
Speedline Breathable Membrane	42
ACCESS PANELS	43



PLASTERBOARDS	17-19
Standard Boards	17
High Performance Boards	18
Specialist Boards	19
Insulating Laminates	19
ANCILLARIES & JOINTING PRODUCTS	20-22
METAL SECTIONS	23-24



STEEL FRAME SYSTEMS	44
----------------------------	-----------



PLASTERBOARDS	25-26
Standard Boards	25
Performance Boards	25-26
Specialist Boards	26
ADHESIVES & FINISHING PRODUCTS	28-29
METALS	30-31



DRY LINING RANGE	45
-------------------------	-----------

TILE BACKER BOARDS RANGE	46
---------------------------------	-----------

ADDITIONAL PRODUCTS & ACCESSORIES

EXTERNAL RENDERS	47-50
Weber	47-48
K-Rend	50

ACCESSORIES	51-52
Stainless Steel Fixing Channels & Accessories	51
Screeding Accessories	51
Chipboard	51
Temporary Site Protection	52
Finnforest Spruce Plywood	52

PRODUCT APPLICATION GUIDE

FIXINGS	53
ALUMINIUM TRIMS	54
BEADS & MESH	55

STANDARD BOARDS

GYPROC WALLBOARD

CODE T/E	CODE S/E	THICKNESS (mm)	WIDTH (mm)	LENGTH (mm)	WEIGHT (per pallet - tonnes)	BOARDS (per pallet)	£ PRICE (per M ²)	£ PRICE (per board)
74010 0136	74015 0757	9.5	900	1800	1.10	100	6.48	10.50
74010 0249	74015 124X		1200	2400	1.80	90	5.69	16.39
74010 1183	74015 2195	12.5	900	1800	1.10	80	6.43	10.42
74010 1208	74015 3609		900	2400	1.50	80	6.43	13.89
74010 1241	74015 2253		1200	2400	1.80	72	5.62	16.19
74010 1570	74015 2275		1200	2500	1.80	72	5.62	16.86
74010 1751	74015 2752		1200	2700	1.70	60	5.62	18.21
74010 2007	74015 3008		1200	3000	1.50	50	5.62	20.23
74010 2506			1200	3600	1.50	40	5.62	24.28
74010 5180		15	900	1800	1.00	60	7.85	12.72
74010 6155	74015 5302		900	2400	1.40	60	7.85	16.96
74010 6132	74015 5400		1200	2400	1.50	50	6.82	19.64
74010 6176			1200	2700	1.40	40	6.82	22.10
74010 6198			1200	3000	1.50	40	6.82	24.55

GYPROC WALLBOARD 4TE

CODE T/E	CODE S/E	THICKNESS (mm)	WIDTH (mm)	LENGTH (mm)	WEIGHT (per pallet - tonnes)	BOARDS (per pallet)	£ PRICE (per M ²)	£ PRICE (per board)
Designed for use in high specification public spaces which feature large wall and ceiling surfaces, and are subject to strong, direct lighting.								
	74013 0125	12.5	2400	1200	1.1	40	9.69	27.91

GYPROC HANDBOARD

CODE T/E	CODE S/E	THICKNESS (mm)	WIDTH (mm)	LENGTH (mm)	WEIGHT (per pallet - tonnes)	BOARDS (per pallet)	£ PRICE (per M ²)	£ PRICE (per board)
	74024 0953	9.5	900	1220	0.80	102	9.03	9.91
	74024 1252	12.5	600	1220	1.10	156	10.76	7.88

GYPROC PLANK

CODE T/E	CODE S/E	THICKNESS (mm)	WIDTH (mm)	LENGTH (mm)	WEIGHT (per pallet - tonnes)	BOARDS (per pallet)	£ PRICE (per M ²)	£ PRICE (per board)
74027 2120	74027 2109	19	600	2400	1.90	80	11.42	16.44

PERFORMANCE BOARDS

GYPROC WALLBOARD TEN

CODE T/E	CODE S/E	THICKNESS (mm)	WIDTH (mm)	LENGTH (mm)	WEIGHT (per pallet - tonnes)	BOARDS (per pallet)	£ PRICE (per M ²)	£ PRICE (per board)
74004 0125		12.5	1200	2400	1.80	60	6.74	19.41

A board with 10kg/m² mass for acoustic applications

GYPROC WALLBOARD DUPLEX

CODE T/E	CODE S/E	THICKNESS (mm)	WIDTH (mm)	LENGTH (mm)	WEIGHT (per pallet - tonnes)	BOARDS (per pallet)	£ PRICE (per M ²)	£ PRICE (per board)
	74052 2181	12.5	900	1800	1.10	80	9.70	15.71
74053 6302	74052 6502		1200	2400	1.80	72	8.44	24.31
74053 6663			1200	2700	1.70	60	8.44	27.35
74053 6765			1200	3000	1.50	50	8.44	30.38
74053 7156		15	1200	2400	1.50	50	10.35	29.81

GYPROC MOISTURE RESISTANT

CODE T/E	CODE S/E	THICKNESS (mm)	WIDTH (mm)	LENGTH (mm)	WEIGHT (per pallet - tonnes)	BOARDS (per pallet)	£ PRICE (per M ²)	£ PRICE (per board)
74016 5404	74016 5459	12.5	1200	2400	1.50	60	8.94	25.75
74016 5492			1200	2700	1.40	50	8.94	28.97
74016 550X			1200	3000	1.60	50	8.94	32.18
74016 6156		15	1200	2400	1.60	50	10.70	30.82

GYPROC FIRELINE

CODE T/E	CODE S/E	THICKNESS (mm)	WIDTH (mm)	LENGTH (mm)	WEIGHT (per pallet - tonnes)	BOARDS (per pallet)	£ PRICE (per M ²)	£ PRICE (per board)
74056 3542	74056 3509	12.5	900	1800	1.40	80	8.28	13.41
74056 416X	74056 4126		1200	2400	1.90	60	7.26	20.91
74056 4501			1200	2700	1.70	50	7.26	23.52
74056 4727			1200	3000	1.90	50	7.26	26.14
74056 6427		15	900	1800	1.30	60	9.94	16.10
74056 6609	74056 6551		1200	2400	1.90	50	8.69	25.03
74056 6676	74056 6675		1200	2700	1.70	40	8.69	28.16
74056 6697			1200	3000	1.90	40	8.69	31.28

Manufacturer direct delivery service charges as per manufacturer's current price list.
Price details available on application to your local branch.

PLASTERBOARDS

5

BRITISH GYPSUM

PERFORMANCE BOARDS - CONTINUED

GYPROC FIRELINE DUPLEX

CODE T/E	CODE S/E	THICKNESS (mm)	WIDTH (mm)	LENGTH (mm)	WEIGHT (per pallet - tonnes)	BOARDS (per pallet)	£ PRICE (per M ²)	£ PRICE (per board)
74056 4181		12.5	1200	2400	1.90	60	11.15	32.11

GYPROC FIRELINE MR

CODE T/E	CODE S/E	THICKNESS (mm)	WIDTH (mm)	LENGTH (mm)	WEIGHT (per pallet - tonnes)	BOARDS (per pallet)	£ PRICE (per M ²)	£ PRICE (per board)
74055 5245		12.5	1200	3000	1.90	50	10.79	38.84
74055 6153		15	1200	3000	1.90	40	12.61	45.40

GYPROC COREBOARD

CODE T/E	CODE S/E	THICKNESS (mm)	WIDTH (mm)	LENGTH (mm)	WEIGHT (per pallet - tonnes)	BOARDS (per pallet)	£ PRICE (per M ²)	£ PRICE (per board)
For use in British Gypsum ShaftWall System								
	74028 119X	19	598	3000	1.80	60	21.14	37.93

GYPROC SOUNDBLOC

CODE T/E	CODE S/E	THICKNESS (mm)	WIDTH (mm)	LENGTH (mm)	WEIGHT (per pallet - tonnes)	BOARDS (per pallet)	£ PRICE (per M ²)	£ PRICE (per board)
74025 0050		12.5	1200	2400	1.94	60	8.75	25.20
74025 0060			1200	2700	1.81	50	8.75	28.35
74025 0070			1200	3000	2.02	50	8.75	31.50
74025 0150		15	1200	2400	2.00	50	10.44	30.07
74025 0160			1200	2700	1.80	40	10.44	33.83
74025 0170			1200	3000	2.00	40	10.44	37.58

Gyproc SoundBloc MR available P.O.A.

GYPROC SOUNDBLOC RAPID

CODE T/E	THICKNESS (mm)	WIDTH (mm)	LENGTH (mm)	WEIGHT (per pallet - tonnes)	BOARDS (per pallet)	£ PRICE (per M ²)	£ PRICE (per board)
Use in conjunction with GypWall metal components							
74008 3240	15	900	2400	1.80	60	9.64	20.82
74008 3250		900	2700	2.00	60	9.64	23.43
74008 3241	15 MR	900	2400	1.80	60	14.10	30.46

GYPROC DURALINE

CODE T/E	CODE S/E	THICKNESS (mm)	WIDTH (mm)	LENGTH (mm)	WEIGHT (per pallet - tonnes)	BOARDS (per pallet)	£ PRICE (per M ²)	£ PRICE (per board)
	74019 0150	15	1200	2400	2.0	50	12.71	36.60
	74019 0151		1200	3000	2.0	40	12.71	45.76

Gyproc Duraline MR also available P.O.A.

GYPROC ERGO900

CODE T/E	CODE S/E	THICKNESS (mm)	WIDTH (mm)	LENGTH (mm)	WEIGHT (per pallet - tonnes)	BOARDS (per pallet)	£ PRICE (per M ²)	£ PRICE (per board)
Specially designed at 900mm wide to give enhanced manual handling properties.								
	74021 0129	12.5	2400	900	1.5	60	12.59	27.19

THERMAL LAMINATES

GYPROC TRILINE

CODE T/E	THICKNESS (mm)	WIDTH (mm)	LENGTH (mm)	WEIGHT (per pallet - tonnes)	BOARDS (per pallet)	£ PRICE (per M ²)	£ PRICE (per board)
Gyproc WallBoard bonded to glass mineral wool.							
74005 1522	52	900	2400	0.50	16	27.61	59.64

Also available in Vapourcheck grade P.O.A.

GYPROC THERMALINE BASIC

CODE T/E	THICKNESS (mm)	WIDTH (mm)	LENGTH (mm)	WEIGHT (per pallet - tonnes)	BOARDS (per pallet)	£ PRICE (per M ²)	£ PRICE (per board)
Gyproc WallBoard bonded to standard expanded polystyrene							
74039 0222	22	1200	2400	0.80	40	8.62	24.83
74039 1302	30	1200	2400	0.70	30	9.51	27.39
74039 1581	40	1200	2400	0.50	20	10.86	31.28

Non-standard sizes (2700mm) in full pallet quantities only, and subject to availability. A 12.5% surcharge on the list price of 2400 x 1200mm board will apply, for 2700mm lengths. 50mm available with integral vapour check.

AN ADDITIONAL WEIGHT LOADING FACTOR APPLIES TO DELIVERY CHARGES FOR LAMINATES. CALL YOUR LOCAL BRANCH FOR DETAILS.

Manufacturer direct delivery service charges as per manufacturer's current price list. Price details available on application to your local branch.

PLASTERBOARDS

THERMAL LAMINATES - CONTINUED

GYPROC THERMALINE PLUS

CODE T/E	THICKNESS (mm)	WIDTH (mm)	LENGTH (mm)	WEIGHT (per pallet - tonnes)	BOARDS (per pallet)	£ PRICE (per M ²)	£ PRICE (per board)
Gyproc WallBoard bonded to standard extruded polystyrene							
74042 0274	27	1200	2400	0.70	30	13.57	39.08
74042 2354	35	1200	2400	0.60	24	15.30	44.06
74042 3401	40	1200	2400	0.50	22	17.05	49.10
74042 4800	48	1200	2400	0.50	19	18.83	54.23

Non-standard sizes (2700mm) in full pallet quantities only and subject to availability.
A 12.5% surcharge on the list price of 2400 x 1200mm board will apply.

GYPROC THERMALINE SUPER

CODE T/E	THICKNESS (mm)	WIDTH (mm)	LENGTH (mm)	WEIGHT (per pallet - tonnes)	BOARDS (per pallet)	£ PRICE (per M ²)	£ PRICE (per board)
Gyproc WallBoard bonded to phenolic foam.							
74047 0300	30	1200	2400	0.6	30	21.87	62.99
74047 0404	40	1200	2400	0.5	22	23.77	68.46
74047 0504	50	1200	2400	0.50	18	26.10	75.17
74047 0605	60	1200	2400	0.40	14	28.90	83.23
74047 0655	65	1200	2400	0.50	12	32.01	92.19
74047 0700	70	1200	2400	0.3	13	35.19	101.35
74047 0800	80	1200	2400	0.3	11	38.04	109.56
74047 0900	90	1200	2400	0.3	10	43.73	125.94

Non-standard sizes (2700mm) in full pallet quantities only, and subject to availability.
A 12.5% surcharge on the list price of 2400 x 1200mm board will apply.

SPECIALIST BOARDS

GLASROC F FIRECASE

CODE T/E	CODE S/E	THICKNESS (mm)	WIDTH (mm)	LENGTH (mm)	WEIGHT (per pallet - tonnes)	BOARDS (per pallet)	M ² (per pallet)	£ PRICE (per M ²)	£ PRICE (per board)
	39514 0155	15	1200	2400	1.25	32		21.36	61.52
	39514 1200	20	1200	2000	1.82	40		25.33	60.79
	39514 2255	25	1200	2000	1.69	30		31.43	75.43
	39514 2300	30	1200	2000	1.34	20		35.51	85.22

GLASROC F MULTIBOARD

CODE T/E	CODE S/E	THICKNESS (mm)	WIDTH (mm)	LENGTH (mm)	WEIGHT (per pallet - tonnes)	BOARDS (per pallet)	M ² (per pallet)	£ PRICE (per M ²)	£ PRICE (per board)
	39515 0961	6	1200	2400	0.90	40	115.20	15.56	44.81
	39515 0983		1200	3000	1.10	40	144.00	15.56	56.02
	39515 1104	10	1200	2400	1.20	40	115.20	29.94	86.23
	39515 112X		1200	3000	1.50	40	144.00	29.94	107.78
	39515 1206	12.5	1200	2400	0.90	32	92.16	39.32	113.24
	39515 128X		1200	3000	1.20	32	115.20	39.32	141.55

GLASROC F SOFFITLINE

CODE T/E	CODE S/E	THICKNESS (mm)	WIDTH (mm)	LENGTH (mm)	WEIGHT (per pallet - tonnes)	BOARDS (per pallet)	M ² (per pallet)	£ PRICE (per M ²)	£ PRICE (per board)
	39517 6264	26	1200	2400	0.76	30		19.54	56.28
	39517 6364	36	1200	2400	0.52	20		23.40	67.39
	39517 6464	46	1200	2400	0.48	18		26.41	76.06
	39517 6456	56	1200	2400	0.44	14		32.12	92.51
	39517 6466	66	1200	2400	0.4	12		37.09	106.83
	39517 6476	76	1200	2400	0.34	10		41.93	120.76
	39517 6486	86	1200	2400	0.36	10		52.65	151.63

GLASROC F FLAMELINE

CODE T/E	CODE S/E	THICKNESS (mm)	WIDTH (mm)	LENGTH (mm)	WEIGHT (per pallet - tonnes)	BOARDS (per pallet)	M ² (per pallet)	£ PRICE (per M ²)	£ PRICE (per board)
	39513 1064	6	600	2400		40	57.6	14.05	20.23
	39513 1104	10	600	2000		40	57.6	27.03	38.92

AN ADDITIONAL WEIGHT LOADING FACTOR APPLIES TO DELIVERY CHARGES FOR LAMINATES. CALL YOUR LOCAL BRANCH FOR DETAILS.

Manufacturer direct delivery service charges as per manufacturer's current price list.
Price details available on application to your local branch.

SPECIALIST BOARDS - CONTINUED

GYPROC RIGIDUR H								
CODE T/E	CODE S/E	THICKNESS (mm)	WIDTH (mm)	LENGTH (mm)	WEIGHT (per pallet - tonnes)	BOARDS (per pallet)	£ PRICE (per M ²)	£ PRICE (per board)
High performance impact resistant gypsum board for use in the GypWall EXTREME system, giving high levels of sound insulation. Class 0 reaction to fire performance.								
	74020 0242	12.5	1200	2400	1.7	40	11.79	33.96
	74020 0280		1200	2800	2.1	40	11.79	39.61
	74020 0300		1200	3000	2.2	40	11.79	42.44
	74020 1150	15	1200	2400	1.6	30	14.53	41.85
	74020 1153		1200	2800	1.9	30	14.53	48.82
	74020 1155		1200	3000	1.6	24	14.53	52.31

FlameLynr components and Firecase fixing screws also available.

BOARDS ALSO OFFERED:

GYPROC PROFILE BOARDS - NEGATIVE EDGE, BEVELLED EDGE	
--	--

FINISHING PRODUCTS

GYPROC COVE

CODE	COMPONENT REFERENCE	LENGTH (mm)	LENGTHS (per carton)	CARTON WEIGHT (kg)	£ PRICE (per Lm)
Sold in full cartons only					
74043 0112	100mm Cove White Liner Paper	3000	6	16	1.50
74043 0303	127mm Cove Ivory Liner Paper	3000	6	20	1.48
74043 0410		3600	5	20	1.48
74043 0510		4200	5	23	1.48
74045 1385	135mm Cornice	3000	6	25	1.75
74045 2015	100mm Cornice Strips	2400	8	26	1.84
74045 2115	25mm Cornice Battens	1200	40	13	0.88

GYPROC COVE ADHESIVE

CODE		BAGS (per pallet)	USAGE	£ PRICE (per bag)
74095 500X	5kg Bags Cove/Cornice Adhesive	200	28 lm/5kg	5.68
74095 5054	12.5kg Bags Cove/Cornice Adhesive	80	28 lm/5kg	11.83

GYPROC SOUNDCOAT PLUS

CODE	BAGS (per pallet)	APPROX COVERAGE (M ² /25KG bag)	£ PRICE (per pallet)	£ PRICE (per bag)
Gypsum based parge coat product, for increasing airtightness of masonry walls to optimise sound and thermal performance.				
74095 0805	56	5	422.80	7.55

GYPROC DRI-WALL ADHESIVE

CODE	SIZE	APPROX COVERAGE (per 100m ²)	BAGS (per pallet)	£ PRICE (per pallet)	£ PRICE (per bag)
A general purpose gypsum based adhesive for use in British Gypsum DriLyner systems.					
74095 0783	25kg	400kg	56	534.80	9.55

GYPROC SEALANT

CODE	SIZE	£ PRICE (per pallet)	£ PRICE (per cartridge)
A general purpose acrylic sealant and adhesive.			
74095 0957	9 x 0.93L	131.04	14.56
74095 0953	12 x 0.38L	99.00	8.25

SEALANT AND MASTIC GUN

CODE	£ PRICE (per item)
A general purpose acrylic sealant and adhesive.	
74094 0200	1 litre mastic gun U3
	22.45

GYPROC READY MIX JOINT CEMENT

CODE	SIZE	APPROX COVERAGE (per 100m ²)	TUBS (per pallet)	£ PRICE (per pallet)	£ PRICE (per tub)
For mechanical jointing using Gyproc Speedtape machines - can also be used as a hand jointing finishing material.					
74095 1075	12L tubs	32-40L	64	1462.40	22.85

GYPROC PROMIX™ LITE JOINT CEMENT

CODE	SIZE	TUBS (per pallet)	£ PRICE (per tub)
Lightweight ready mix jointing material for the finishing stage over Gyproc Joint Filler or for all stages with mechanical tools.			
74095 1071	17L tubs	36	33.90

SANDING PAPER

CODE	£ PRICE (per pack)
74094 0440	Sanding Paper (Pack of 25)
	10.46

GYPROC DRYWALL PRIMER / SEALER

CODE	SIZE	TUBS (per pallets)	COVERAGE (100m ²)	£ PRICE (per pallet)	£ PRICE (per tub)
A general purpose plasterboard primer.					
74095 5300	Primer 10L tubs	48	8-9L	2184.48	45.51
74095 5305	Sealer 10L tubs	48	14-15L	2910.24	60.63

GYPROC JOINT CEMENT

CODE	SIZE	APPROX COVERAGE (per 100m ²)	BAGS (per pallet)	£ PRICE (per pallet)	£ PRICE (per bag)
For mechanical jointing using Gyproc Speedtape machines - can also be used as a hand jointing finishing material.					
74095 1095	22.5kg bags	40-50kg	40	1328.40	33.21

GYPROC JOINT FILLER

CODE	SIZE	APPROX COVERAGE (per 100m ²)	BAGS (per pallet)	£ PRICE (per pallet)	£ PRICE (per bag)
For hand jointing on tapered edge wallboard - filler material.					
74095 1009	12.5kg bags	20-25kg	80	903.20	11.29

FINISHING PRODUCTS

9

BRITISH GYPSUM

GYPROC FIRESTRIP

CODE	LENGTH (mm)	NO. LENGTHS (per pack)	£ PRICE (per pack)
A soft extruded linear gap sealer for use in deflection detail with GypWall & ShaftWall systems			
74095 0100	3600	5	52.07

GYPROC EASI-FILL

CODE	SIZE	APPROX COVERAGE (per 100m ²)	BAGS (per pallet)	£ PRICE (per pallet)	£ PRICE (per bag)
For hand jointing on tapered edge wallboard - combined filler and finish.					
74095 1060	Easifill	10kg bags	40kg	80	1480.80
74095 1061	Easifill 45	10kg bags	40kg	80	1480.80

GYPROC JOINT TAPE

CODE	APPROX COVERAGE (per 100m ²)	£ PRICE (per box)	£ PRICE (per roll)
For joint reinforcement by hand or using Gyproc Speedtape machines.			
74095 1100	Box of 10 x 150m rolls	1 roll	57.60

GYPROC CORNER TAPE

CODE	£ PRICE (per box)	£ PRICE (per roll)
For external angle reinforcement.		
74095 1520	Box of 5 x 33m rolls	134.80

GYPROC CONTROL JOINT

CODE	SIZE (mm)	LENGTH (mm)	£ PRICE (per carton)	£ PRICE (per lm)
Movement joint for drywall applications. Carton of 10 lengths.				
74095 1858	3048		340.46	11.17

GYPROC DRYWALL METAL ANGLE BEAD

CODE	SIZE (mm)	LENGTH (mm)	£ PRICE (per carton)	£ PRICE (per lm)
For external angle reinforcement. Carton of 20 lengths.				
41730 2400	25 x 25	2400	183.84	3.83
41730 3006	25 x 25	3000	229.80	3.83

GYPROC DRYWALL ARCHBEAD

CODE	SIZE (mm)	LENGTH (mm)	£ PRICE (per carton)	£ PRICE (per lm)
A flexible plastic angle bead for reinforcement of arches and curved reveals. Carton of 50 lengths.				
41735 3001	25 x 25	3000	472.50	3.15

GYPROC DRYWALL METAL EDGE BEAD

CODE	SIZE (mm)	LENGTH (mm)	£ PRICE (per carton)	£ PRICE (per lm)
Board edge trim, 9.5mm, 12.5mm or 15mm Gyproc WallBoard. Carton of 20 lengths.				
41731 2405	12.5	2400	72.96	1.52
41731 300X		3000	90.00	1.50
41731 4156	15	3000	99.60	1.66

GYPROC DRYWALL PLASTIC EDGE BEAD

CODE	SIZE (mm)	LENGTH (mm)	£ PRICE (per carton)	£ PRICE (per lm)
Board edge trim for 12.5mm Gyproc WallBoard. Carton of 20 lengths.				
41731 3030	12.5	3000	69.60	1.16

GYPROC STYLETRIMS

CODE	COMPONENT REFERENCE	WIDTH (mm)	DEPTH (mm)	No. (per box)	METRES (per box)	£ PRICE (per box)
A range of aluminium dry lining trims.						
41711 1105	BGM 105 Edge Reveal	25	10	20	60	439.64
41711 1106	BGM 106 Edge Reveal	12.5	10	20	60	365.57
41711 1119	BGM 119 Edge Stop		12.5	20	60	388.61

GYPROC NO-COAT ULTRA

CODE	SIZE	£ PRICE (per box)
Corner reinforcement for jointed systems.		
41746 0325	No-coat Ultraflex 325	30m roll

CODE	LENGTHS (per box)	LENGTH (mm)	£ PRICE (per box)
41746 0400	No-coat Ultratrim L	50	3050

PLASTERS & PLASTER ACCESSORIES

THISTLE PLASTER BONDING AGENTS

CODE		TUB SIZE	COVERAGE (100m ²)	£ PRICE (per tub)
ThistleBond-It: Bonding agent for pre treatment of smooth backgrounds. GypPrime: Suction control primer for high suction backgrounds.				
74095 1191	ThistleBond-It	10L	20L	56.69
74095 1180	GypPrime	11L	11L	98.70

THISTLE UNDERCOAT PLASTERS

CODE	PRODUCT	BAGS (per pallet)	APPROX COVERAGE (m ² /25kg bag)	£ PRICE (per pallet)	£ PRICE (per bag)
74065 0570	Thistle Browning	40	3.4 – 3.9	321.56	8.04
74065 0580	Thistle Tough Coat	40	3.4 – 3.8	331.10	8.28
74065 0530	Thistle Bonding Coat	56	2.3 – 2.5	450.18	8.04
74065 0592	Thistle Hardwall	45	2.9 – 3.1	361.75	8.04
74065 0675	Thistle Dri-Coat	40	3.1 – 3.4	691.97	17.30
74065 0621	Thistle X-Ray	56	0.75	1316.56	23.51

THISTLE ONE COAT PLASTERS

CODE	PRODUCT	BAGS (per pallet)	APPROX COVERAGE (m ² /25kg bag)	£ PRICE (per pallet)	£ PRICE (per bag)
74065 0596	Thistle Universal One Coat	56	2.7 – 3.0	542.87	9.69
74065 0652	Thistle Projection	56	2.4 – 2.6	444.86	7.94

THISTLE FINISH COAT PLASTERS

CODE	PRODUCT	BAGS (per pallet)	APPROX COVERAGE (m ² /25kg bag)	£ PRICE (per pallet)	£ PRICE (per bag)
74065 0562	Thistle Board Finish	56	6.5 – 6.8	310.80	5.55
74065 0642	Thistle Multi Finish	56	6.7 – 7.0	338.80	6.05

THISTLE PROTAPE FT50 & FT100

CODE		£ PRICE (per box)	£ PRICE (per roll)
A self adhesive glass fibre mesh tape for joint reinforcement.			
74096 0506	Box of 24 rolls x 90m FT50	105.60	4.40
74096 1005	Box of 12 rolls x 45m FT100	84.21	7.02

THISTLE PLASTER ANGLE BEAD

CODE		LENGTH (mm)	£ PRICE (per carton)	£ PRICE (per lm)
A galvanised steel bead reinforcing external angles.				
41739 0242	Carton of 50 lengths	2400	258.00	2.15
41739 0302		3000	399.00	2.66

THISTLE PLASTER STOP BEAD

CODE		THICKNESS (mm)	LENGTH (mm)	£ PRICE (per carton)	£ PRICE (per lm)
A galvanised steel bead to provide an end stop.					
41738 2402	Carton of 50 lengths	10	2400	166.80	1.39
41738 3002		10	3000	208.50	1.39
41738 2412	Carton of 50 lengths	13	2400	166.80	1.39
41738 3012		13	3000	208.50	1.39

THISTLE THIN COAT PLASTER STOP BEAD

CODE		THICKNESS (mm)	LENGTH (mm)	£ PRICE (per carton)	£ PRICE (per lm)
A bead with perforated wings for finishing and reinforcing edges of thin coat plaster.					
41737 2402	Carton of 50 lengths	3	2400	174.00	1.45
41737 3002			3000	217.50	1.45

THISTLE THIN COAT MINI MESH BEAD

CODE		LENGTH (mm)	£ PRICE (per carton)	£ PRICE (per lm)
A bead with mesh wings which provides excellent key for thin-coat plaster corners.				
41740 2402	Carton of 50 lengths	2400	278.40	2.32
41740 3002		3000	432.00	2.88

THISTLE THIN COAT ANGLE BEAD

CODE		LENGTH (mm)	£ PRICE (per carton)	£ PRICE (per lm)
A "thin-coat" bead with perforated wings for reinforcing external angles.				
41736 2402	Carton of 50 lengths	2400	289.20	2.41
41736 3002		3000	451.50	3.01

GYPFRAME METAL REFERENCE CODES

The first 2 or 3 digits refer to the component width, the letters refer to the component type and the last two numbers indicate metal thickness in mm e.g. 60 S 50 refers to rigidised 60mm Stud 0.50mm gauge or equivalent. Components with gauge 0.50 or 0.60mm are manufactured using the patented "Ultrasteel" process giving equivalent system performance as systems using metal of gauge 0.55 and 0.70mm respectively.

KEY	COMPONENT	FLANGE DIMENSION (mm)
S	C Stud	32/34
I	I Stud	38
C	Channel	32
DC	Deep Flange Channel	50
EDC	Extra Deep Flange Channel	70
JC	J Channel	50/70
SC	Starter Channel	32
FC	Fixing Channel 100mm web	10
T	Tabbed	-

COMPONENT
55 = 0.55mm or rigidised equivalent (0.50mm)
70 = 0.70mm or rigidised equivalent (0.60mm)
90 = 0.90 mm or equivalent
12 = 1.2mm or equivalent

NON-STOCK LENGTHS

GypFrame metal is available in non-stock lengths to special order subject to an extended lead time, a minimum order quantity and a 10% service charge.

GYPWALL METAL STUD PARTITION

Metal stud partition can be used as a cost effective space divide for all types of commercial, recreational and industrial buildings.

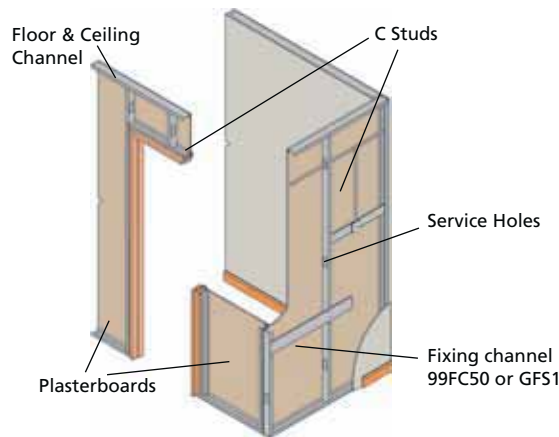

GYPFRAME C STUDS

CODE	COMPONENT REFERENCE	LENGTH (mm)	LENGTHS (per pack)	£ PRICE (per pack)	£ PRICE (per lm)
For use in British Gypsum Partitions and Wall systems.					
41712 0027	48 S 50	2400	10	56.40	2.35
41712 0049		2700	10	63.50	2.35
41712 0060		3000	10	70.50	2.35
41712 0107		3600	10	84.60	2.35
41712 0367	60 S 50	3000	10	95.40	3.18
41712 0403		3600	10	114.50	3.18
41712 0606	70 S 50	2400	10	72.30	3.01
41712 0628		2700	10	81.30	3.01
41712 0661		3000	10	90.30	3.01
41712 0708		3600	10	108.40	3.01
41712 0711		4200	10	126.50	3.01
41712 0765	70 S 60	3600	10	229.70	6.38
41712 0776		4200	10	268.00	6.38
41712 0722	70 S 65	2395	10	150.40	6.28
41712 0723		2695	10	169.30	6.28
41712 0896	92 S 10	3600	10	447.50	12.43
41712 0902		4200	10	522.10	12.43
41712 0928	92 S 50	3600	10	155.90	4.33
41712 0926		4200	10	181.90	4.33
41712 0960	92 S 60	4200	10	342.80	8.16
41712 1042	146 S 50	3000	10	153.30	5.11
41712 1064		3600	10	184.00	5.11
41712 1097		4200	10	214.70	5.11

METAL PRODUCTS

GYPFRAME ACOUSTUDS

CODE	COMPONENT REFERENCE	LENGTH (mm)	LENGTHS (per pack)	£ PRICE (per pack)	£ PRICE (per lm)
41713 0432	43 AS 50	2395	10	87.50	3.65
41713 0433		2695	10	98.40	3.65
41713 0700	70 AS 50	2400	10	150.80	6.28
41713 0701		2700	10	169.60	6.28
41713 0702		3000	10	188.40	6.28
41713 0704		3600	10	226.10	6.28
41713 0705		4200	10	263.80	6.28
41713 0923	92 AS 50	3600	10	278.28	7.73
41713 0942		4200	10	324.66	7.73
41713 1450	146 AS 50	2700	10	243.00	9.00
41713 1455		3000	10	270.00	9.00
41713 1460		3600	10	324.00	9.00

GYPFRAME I STUDS

CODE	COMPONENT REFERENCE	LENGTH (mm)	LENGTHS (per pack)	£ PRICE (per pack)	£ PRICE (per lm)
For use in GypWall metal stud partitions, Gyplyner IWL and ShaftWall Systems.					
41712 1984	48 I 50	2700	10	161.00	5.96
41712 1985		3000	10	178.80	5.96
41712 2236	60 I 50	2700	10	152.10	5.63
41712 2233		3600	10	202.70	5.63
41712 2453	60 I 70	3600	10	257.40	7.15
41712 246X		4200	10	300.30	7.15
41712 2505	70 I 50	3600	10	222.20	6.17
41712 2507		4200	10	259.20	6.17
41712 2555	70 I 70	3600	10	331.20	9.20
41712 2566		4200	10	386.40	9.20
41712 2650	92 I 90	3600	10	341.70	9.49
41712 267X		5000	10	474.50	9.49
41712 268X		6000	10	569.40	9.49
41712 8102	146 TI 90 Tabbed I Stud	5000	10	817.00	16.34
41712 8103		6000	10	980.40	16.34
41712 2695	146 I 80	5000	10	680.00	13.60
41712 2696		6000	10	816.00	13.60

GYPFRAME FLOOR & CEILING CHANNELS

CODE	COMPONENT REFERENCE	LENGTH (mm)	LENGTHS (per pack)	£ PRICE (per pack)	£ PRICE (per lm)
For use in GypWall metal stud partitions, Gyplyner IWL and ShaftWall Systems.					
Standard Channels.					
41712 3003	50 C 50	3600	10	92.60	2.57
41712 4007	62 C 50	3600	10	104.40	2.90
41712 5009	72 C 50	3600	10	110.60	3.07
41712 5424	94 C 50	3600	10	128.90	3.58
41712 6003	148 C 50	3600	10	167.10	4.64
Deep Flange Channels					
41712 3107	50 DC 60	3600	10	184.40	5.12
41712 4201	62 DC 60	3600	10	206.30	5.73
41712 5100	72 DC 60	3600	10	218.90	6.08
41712 5450	94 DC 60	3600	10	247.00	6.86
41712 6103	148 DC 60	3600	10	275.40	7.65
Extra Deep Flange Channels					
41712 3151	50 EDC 70	3600	10	303.50	8.43
41712 5508	72 EDC 80	3600	10	358.20	9.95
41712 5805	94 EDC 70	3600	10	415.80	11.55
41712 6205	148 EDC 80	3600	10	471.30	13.09

CASOLINE MF CEILING CHANNELS & ACCESSORIES

A simple to install suspended ceiling often used to reduce ceiling height or for rooms within warehouses and factories.

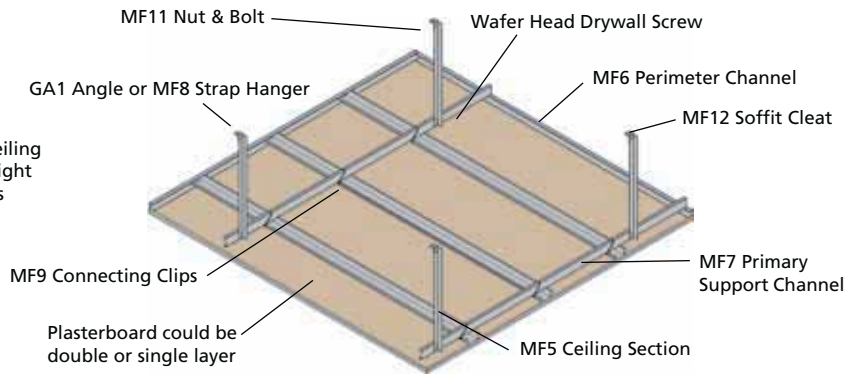

CODE	COMPONENT REFERENCE	DIMENSIONS (mm)	LENGTH (mm)	No. LENGTHS (per pack)	APPROX QRT (per 100m ² of ceiling)	£ PRICE (per pack)	£ PRICE (per lm)
41715 1101	MF5 Ceiling Section	80 x 26 x 0.55	3600	10	230m	83.16	2.31
41715 1203	MF6 Perimeter Channel	20 x 27 x 30 x 0.50	3600	10	Varies	61.92	1.72
41715 1305	MF7 Primary Support Channel	15 x 45 x 0.90	3600	10	80m	93.24	2.59
41715 1320	MF7C Curved Support Channel	Bespoke radius	3600	MOQ 108lm			17.10
41715 1407	MF8 Strap Hanger	25 x 0.55	25m per coil	1	64m	22.58	
41729 0211	GA1 Steel Angle	25 x 25 x 0.5	2900	10		46.69	1.60
41715 1450	MF9 Connecting Clip	2.65 gauge		200	84	126.86	
41715 1655	MF11 Nut & Bolt	6 x 12.0		200	96	30.28	
41715 1705	MF12 Soffit Cleat	27 x 37 x 25 x 1.6		100	64	28.17	
41734 0100	Wafer Head Drywall Screws	13		1000		19.06	
41726 0254	Drywall Screws	25		1000	1800/Layer	11.99	
41726 0367		36		1000	1800/Layer	16.12	
41726 0425		42		1000	1800/Layer	18.41	

INDICATIVE COST/M² OF MF SUSPENDED CEILING METAL

CODE	COMPONENT REFERENCE	QUANTITY (per m ²)	£ PRICE
41715 1101	MF5 Ceiling Section	2.3 LM	5.31
41715 1305	MF7 Primary Support Channel	0.8 LM	2.07
41715 1450	MF9 Connecting Clip	2.0 No.	1.27
41715 1203	MF6 Perimeter Channel	1.0 LM	1.72

TOTAL	10.37
--------------	--------------

GYPLYNER CHANNELS & ACCESSORIES

An internal metal lining system used in houses and commercial buildings - the created cavity allows for services.

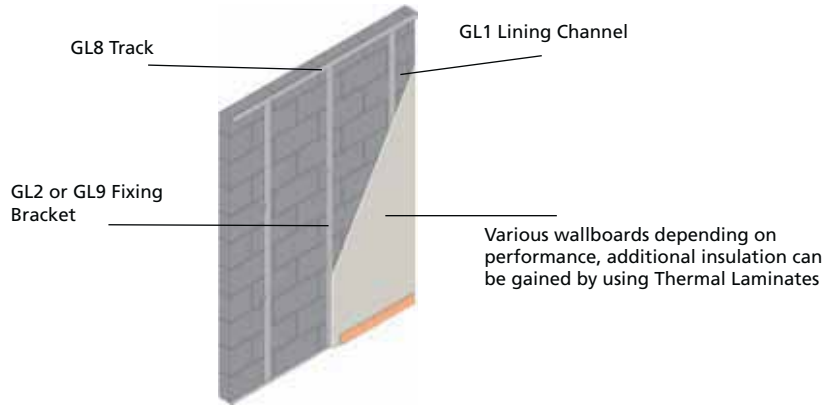

CODE	COMPONENT REFERENCE	LENGTH (mm)	LENGTHS (per pack)	£ PRICE (per pack or item)	£ PRICE (per lm)
A steel framed lining system for walls and ceilings.					
41701 0128	GL1 Channel	2400	10	65.30	2.72
41701 0129		2700	10	73.50	2.72
41701 0130		3000	10	81.60	2.72
41701 0136		3600	10	98.00	2.72
41701 0201	GL2 Bracket (supplied flat)	195	100	116.49	
41701 0301	GL3 Channel Connector		50	46.18	
41701 1500	GL5 Timber Connector	70	200	128.30	
41701 1600	GL6 Timber Connector	170	100	88.09	
41734 0100	Wafer Head Drywall Screw	13	1000	19.06	
41701 1800	GL8 Track	3600	10	76.27	2.12
41701 1900	GL9 Bracket (supplied flat)	295	100	295.67	
41701 2000	GL10 GypLyner Steel Framing Clips (single clip for steelwork flanges up to 28mm)		100	356.23	
41729 0232	GA2 Angle 25 x 25 x 0.7mm	3200	10	67.90	2.12
41701 9200	GL11 GypLyner Anchors		100	77.97	
41701 2010	GL12 GypLyner Bracket (supplied flat)	395	100	277.41	
41705 2800	MF 10 Channel	2800	10	65.30	2.33

SHAFTWALL STARTER CHANNELS & ACCESSORIES

CODE	COMPONENT REFERENCE	LENGTH (mm)	LENGTHS (per pack)	£ PRICE (per pack)	£ PRICE (per lm)
'J' Channel					
41712 3707	62 JC 70	3600	10	253.10	7.03
Starter Channel					
41712 364X	60 SC 55	3600	10	164.60	4.57
41712 5720	70 SC 70	3600	10	229.70	6.38
41712 5724		4200	10	268.00	6.38
41712 5985	92 SC 90	5000	10	387.50	7.75
41712 598X		6000	10	465.00	7.75
Tabbed Starter Channel					
41712 8119	146 TSC 90	5000	10	734.00	14.68
41712 811X		6000	10	880.80	14.68
41712 8350	Service Support Plate	130	100	137.27	
41729 0332	GA3 Steel Angle 32 x 19 x 0.7mm	3200	10	88.00	2.75
41712 8201	G102 Retaining Channel	2400	10	63.40	2.64
41712 8309	G105 Retaining Channel	2400	10	104.40	4.35
41712 8330	G110 Retaining Channel	2400	10	104.40	4.35
41712 8325	G108 Retaining Clips		100	243.95	
41712 8237	G109 Retaining Clips		100	400.26	

GYPFLOOR SILENT FLOOR CHANNELS & ACCESSORIES

A Sound Insulating floor system designed for use in residential applications. Ideal for flat conversions

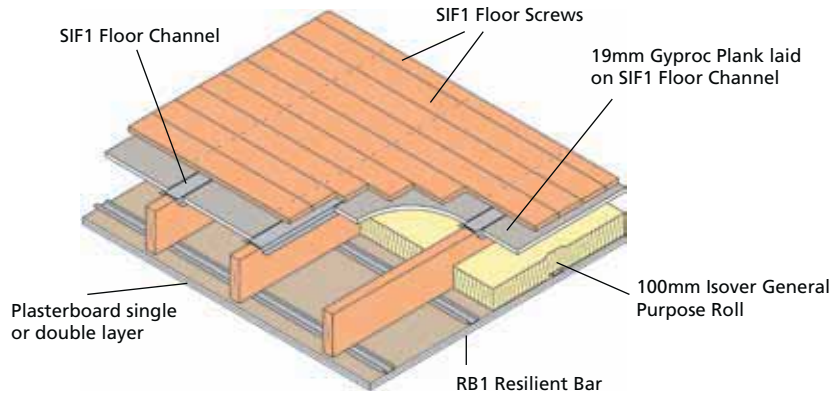

CODE	COMPONENT REFERENCE	LENGTH MM (mm)	QUANTITY (per pack)	£ PRICE (per pack)	£ PRICE (per lm)
41789 1012	SIF1 Channel	2000	10	346.60	17.33
41789 2012	SIF2 Channel	2000	10	316.40	15.82
41789 4002	SIF4 Channel	2000	10	350.00	17.50
41789 8055	SIF5 Floor Screws	55	1000	72.62	
41712 8342	RB1 Resilient Bar	3000	10	94.50	3.15

GYPFLOOR SB STEEL BATTENS & ACCESSORIES

Battens and associated components which make up the GypFloor SB system. For use with both timber and masonry separating floors.

CODE	DESCRIPTION	LENGTH (mm)	No. OF ITEMS (per pack)	WEIGHT (kg)	£ PRICE (per pack)
41790 0500	50 SB 65 Steel Batten	1800	10	15	107.46
41790 0700	70 SB 65 Steel Batten	1800	10	16	134.10
41790 3000	SB3 Flanking Strip	10m	5	10	63.20
41790 4000	SB4 Levelling Cradle		25	1	63.25
41790 5000	SB5 Levelling Packer		100	1	22.00

GYPWALL RAPID / QUIET STUDS CHANNELS & ACCESSORIES

GYPWALL RAPID

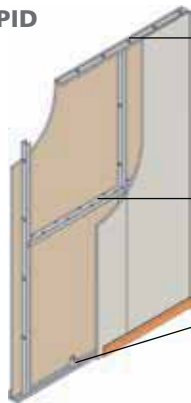

GYPWALL QUIET

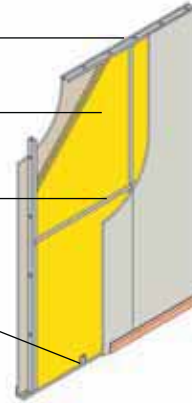

CODE	COMPONENT REFERENCE	LENGTH (mm)	LENGTHS (per carton)	£ PRICE (per pack)	£ PRICE (per lm)
41712 0722	GWR5'C Stud (70 S 65)	2395	10	150.41	6.28
41712 0723		2695	10	169.25	6.28
41702 0091	GWR2-43mm Nogging Channel	896	10	46.05	5.14
41702 0111	GWR6-70mm Nogging Channel	896	10	52.86	5.90
41702 0133	GWR3-45mm Channel (45 C 50)	2400	10	36.48	1.52
41702 0153	GWR7-72mm Channel (72 C 50)	2400	10	82.32	3.43
41702 0160	GWR4-43mm Skirting Block	150	50	202.57	
41702 0162	GWR8-70mm Skirting Block	150	50	247.22	
41726 0323	Drywall Screws	32	1000	12.88	
41734 0100	Wafer Head Screws	13	1000	19.06	

*The quantities will vary considerably depending on the joist layout and size of rooms, therefore the figures given should be used only as a guide. Those shown relate to joists of 55mm or less at 400mm centres.

**SIF3 clip only used on joists of 55mm or less thickness.

METAL PRODUCTS

GYPFRAME FIXING CHANNELS

CODE	COMPONENT REFERENCE	LENGTH (mm)	LENGTHS (per pack)	£ PRICE (per pack)	£ PRICE (per lm)
41712 8015	150 FC 90 Fixing Channel	1197	10	120.20	10.04
41712 8007	99 FC 50 Fixing Channel	2400	10	137.52	5.73

GYPFRAME BOARD JOINTING COMPONENTS

CODE	COMPONENT REFERENCE	LENGTH (mm)	LENGTHS (per pack)	£ PRICE (per pack)	£ PRICE (per lm)
41712 8410	GFS1 Fixing Strap	2400	10	71.10	2.96
41712 8405	GFT1 Fixing 'T'	2400	10	99.90	4.16

GYPFRAME CURVELYNER CHANNEL

CODE	COMPONENT REFERENCE	SIZE (mm)	NO. (per pack)	£ PRICE (per pack)	£ PRICE (per lm)
41712 5120	72 EDCL 80	2000	10	270.00	13.50

GYPFRAME STEEL ANGLES

CODE	COMPONENT REFERENCE	LENGTH (mm)	NO. (per pack)	£ PRICE (per pack)	£ PRICE (per lm)
41729 0211	GA1 Steel Angle 25 x 25 x 0.5mm	2900	10	46.70	1.61
41729 0232	GA2 Steel Angle 25 x 25 x 0.7mm	3200	10	67.90	2.12
41729 0332	GA3 Steel Angle 32 x 19 x 0.7mm	3200	10	88.00	2.75
41729 0350	GA4 Steel Angle 50 x 25 x 0.7mm	3660	10	141.70	3.87
41729 0360	GA5 Internal Fixing Angle	3600	10	230.80	6.41
41729 0370	GA6 Splayed Angle	2400	10	143.10	5.96
41729 0372	GA6 Splayed Angle	3600	10	214.60	5.96

GYPFRAME STAGGERED STUD CLIPS

CODE	COMPONENT REFERENCE	NO. (per pack)	£ PRICE (per pack)
41712 8800	C1 Spacer Clip	100	81.22
41712 8802	SC2 Spacer Clip	100	125.79

GYPFRAME ACOUSTIC BRACE

CODE	COMPONENT REFERENCE	LENGTH (mm)	NO. OF ITEMS (per pack)	£ PRICE (per pack)	£ PRICE (per lm)
41712 8606	GAB3 Acoustic Brace	459	25	190.04	

GYPFRAME SOUND INSULATING BARS

CODE	COMPONENT REFERENCE	LENGTH (mm)	NO. OF ITEMS (per pack)	£ PRICE (per pack)	£ PRICE (per lm)
41712 8342	RB1 Resilient Bar	3000	10	94.50	3.15
41712 8340	RB2 SureFix Bar	3000	10	72.30	2.41

GYPFRAME ACOUSTIC HANGERS

CODE	COMPONENT REFERENCE	LENGTH (mm)	NO. OF ITEMS (per pack)	£ PRICE (per pack)	£ PRICE (per lm)
41712 8650	GAH1 Acoustic Hangers	35	100	1042.17	
41712 8652	GAH2 Acoustic Hangers	70	100	1128.45	

GYPFRAME SKIRTING PLATES

CODE	COMPONENT REFERENCE	SIZE (mm)	NO. OF ITEMS (per pack)	£ PRICE (per pack)	£ PRICE (per lm)
41712 8310	G106 Skirting Plate	12.5	100	182.29	

GYPFRAME SECURITY SHEET

CODE	SIZE (mm)	NO. OF ITEMS (per pack)	£ PRICE (per pack)	£ PRICE (per lm)
74058 0095	3000 x 1070	1	151.05	47.05

OTHER BRITISH GYPSUM PRODUCTS ARE AVAILABLE

STANDARD BOARDS

KNAUF WALLBOARD

CODE T/E	CODE S/E	THICKNESS (mm)	WIDTH (mm)	LENGTH (mm)	WEIGHT (per pallet - tonnes)	BOARDS (per pallet)	£ PRICE (per m ²)	£ PRICE (per board)
	73702 0050	9.5	900	1800	1.01	100	6.38	10.33
73701 0300	73702 0300		1200	2400	1.65	92	5.63	16.21
73701 1050	73702 1050	12.5	900	1800	1.06	80	6.50	10.53
73701 1150	73702 1150		900	2400	1.41	80	6.50	14.04
73701 1300	73702 1300		1200	2400	1.69	72	5.73	16.50
73701 2060			1200	2500	1.76	72	5.73	17.19
73701 1400	73702 1400		1200	2700	1.58	60	5.73	18.57
73701 1450	73702 1450		1200	3000	1.76	60	5.73	20.63
73701 2065		15	900	1800	1.00	60	7.76	12.57
73701 2000	73702 1950		900	2400	1.33	60	7.76	16.76
73701 2050	73702 2050		1200	2400	1.77	60	6.86	19.76
73701 2070			1200	2700	1.60	48	6.86	22.23
73701 2200			1200	3000	1.77	48	6.86	24.70

KNAUF BASEBOARD

CODE T/E	CODE S/E	THICKNESS (mm)	WIDTH (mm)	LENGTH (mm)	WEIGHT (per pallet - tonnes)	BOARDS (per pallet)	£ PRICE (per m ²)	£ PRICE (per board)
	73713 0295	9.5	900	1220	0.64	96	7.08	7.77

KNAUF PLANK

CODE T/E	CODE S/E	THICKNESS (mm)	WIDTH (mm)	LENGTH (mm)	WEIGHT (per pallet - tonnes)	BOARDS (per pallet)	£ PRICE (per m ²)	£ PRICE (per board)
73736 4196		19	600	2400	1.61	80	12.47	17.96

KNAUF VAPOURSHIELD

CODE T/E	CODE S/E	THICKNESS (mm)	WIDTH (mm)	LENGTH (mm)	WEIGHT (per pallet - tonnes)	BOARDS (per pallet)	£ PRICE (per m ²)	£ PRICE (per board)
	73705 1050	12.5	900	1800	1.06	80	10.22	16.56
73703 1300	73705 1300		1200	2400	1.69	72	8.80	25.34
73703 1380			1200	3000	1.76	60	8.80	31.68
73703 1504		15	1200	2400	1.77	60	10.72	30.87

KNAUF FUTUREPANEL

CODE T/E	CODE S/E	THICKNESS (mm)	WIDTH (mm)	LENGTH (mm)	WEIGHT (per pallet - tonnes)	BOARDS (per pallet)	£ PRICE (per m ²)	£ PRICE (per board)
73712 0120		12.5	1200	2400	1.73	60	7.94	22.87
73712 0123				2500	1.80	60	7.94	23.82
73712 0125				2700	1.94	60	7.94	25.73

PLASTERBOARDS

HIGH PERFORMANCE BOARDS

KNAUF SOUNDSHIELD

CODE T/E	CODE S/E	THICKNESS (mm)	WIDTH (mm)	LENGTH (mm)	WEIGHT (per pallet - tonnes)	BOARDS (per pallet)	£ PRICE (per m ²)	£ PRICE (per board)
73754 0125		12.5	1200	2400	1.95	56	9.33	26.87
73754 0127			1200	2700	1.88	48	9.33	30.23
73754 0130			1200	3000	1.82	42	9.33	33.59
73754 0155		15	1200	2400	1.92	48	11.33	32.63
73754 0157			1200	2700	0.89	20	11.33	36.71
73754 0160			1200	3000	1.00	20	11.33	40.79

KNAUF IMPACT PANEL

CODE T/E	CODE S/E	THICKNESS (mm)	WIDTH (mm)	LENGTH (mm)	WEIGHT (per pallet - tonnes)	BOARDS (per pallet)	£ PRICE (per m ²)	£ PRICE (per board)
73746 1295		12.5	1200	2400	1.86	60	11.62	33.47
73746 1402				3000	1.84	48	11.62	41.83
73746 1502		15	1200	3000	1.95	42	13.45	48.42

KNAUF MOISTURESHIELD

CODE T/E	CODE S/E	THICKNESS (mm)	WIDTH (mm)	LENGTH (mm)	WEIGHT (per pallet - tonnes)	BOARDS (per pallet)	£ PRICE (per m ²)	£ PRICE (per board)
73709 1300	73710 1300	12.5	1200	2400	1.74	60	9.60	27.65
73709 1310			1200	2700	1.95	60	9.60	31.10
73709 1450			1200	3000	1.95	54	9.60	34.56

KNAUF SOUND MOISTURESHIELD

CODE T/E	CODE S/E	THICKNESS (mm)	WIDTH (mm)	LENGTH (mm)	WEIGHT (per pallet - tonnes)	BOARDS (per pallet)	£ PRICE (per m ²)	£ PRICE (per board)
73763 0125		12.5	1200	2400	0.98	28	12.46	35.88
73763 0128			1200	3000	0.86	20	12.46	44.86
73763 0155		15	1200	2400	1.92	48	13.98	40.26
73763 0159			1200	3000	1.8	36	13.98	50.33

KNAUF FIRESHIELD

CODE T/E	CODE S/E	THICKNESS (mm)	WIDTH (mm)	LENGTH (mm)	WEIGHT (per pallet - tonnes)	BOARDS (per pallet)	£ PRICE (per m ²)	£ PRICE (per board)
73706 1050	73707 1050	12.5	900	1800	1.30	80	8.89	14.40
73706 1300	73707 1300		1200	2400	1.73	60	7.76	22.35
73706 1400			1200	2700	1.94	60	7.76	25.14
73706 1450			1200	3000	1.73	48	7.76	27.94
73706 2140		15	1200	2400	1.66	48	9.56	27.53
73706 2150			1200	2700	1.87	48	9.56	30.97
73706 2200			1200	3000	1.04	24	9.56	34.42

KNAUF FIRE MOISTURESHIELD

CODE T/E	CODE S/E	THICKNESS (mm)	WIDTH (mm)	LENGTH (mm)	WEIGHT (per pallet - tonnes)	BOARDS (per pallet)	£ PRICE (per m ²)	£ PRICE (per board)
73747 0124		12.5	1200	3000	1.01	28	9.27	33.37
73747 0170		15	1200	3000	0.93	24	11.03	39.71

KNAUF TOUGHPANEL

CODE T/E	CODE S/E	THICKNESS (mm)	WIDTH (mm)	LENGTH (mm)	WEIGHT (per pallet - tonnes)	BOARDS (per pallet)	£ PRICE (per m ²)	£ PRICE (per board)
73768 0150		15	1200	2400	1.15	25	24.25	69.84

KNAUF CORE BOARD

CODE T/E	CODE S/E	THICKNESS (mm)	WIDTH (mm)	LENGTH (mm)	WEIGHT (per pallet - tonnes)	BOARDS (per pallet)	£ PRICE (per m ²)	£ PRICE (per board)
	73748 0190	19	600	3000	0.94	32	20.22	36.40

SPECIALIST BOARDS

KNAUF AQUAPANEL INTERIOR CEMENT BOARD

CODE T/E	CODE S/E	THICKNESS (mm)	WIDTH (mm)	LENGTH (mm)	WEIGHT (per pallet - tonnes)	BOARDS (per pallet)	£ PRICE (per m ²)	£ PRICE (per board)
73745 1123		12.5	900	1200	0.81	50	25.59	27.64
73745 1127		12.5	900	2400	0.81	25	25.59	55.27

KNAUF AQUAPANEL EXTERIOR CEMENT BOARD

CODE T/E	CODE S/E	THICKNESS (mm)	WIDTH (mm)	LENGTH (mm)	WEIGHT (per pallet - tonnes)	BOARDS (per pallet)	£ PRICE (per m ²)	£ PRICE (per board)
73745 1121		12.5	900	2400	0.87	25	25.59	55.27

KNAUF AQUAPANEL THERMAL BOARD

CODE T/E	CODE S/E	THICKNESS (mm)	WIDTH (mm)	LENGTH (mm)	WEIGHT (per pallet - tonnes)	BOARDS (per pallet)	£ PRICE (per m ²)	£ PRICE (per board)
73745 1102		10	600	1200	0.1	50	39.62	28.53

KNAUF AQUAPANEL FLOOR TILE UNDERLAY

CODE T/E	THICKNESS (mm)	WIDTH (mm)	LENGTH (mm)	WEIGHT (per pallet - tonnes)	BOARDS (per pallet)	£ PRICE (per m ²)	£ PRICE (per board)
73745 2700	6	900	1200	0.88	100	23.30	25.16

INSULATING LAMINATES

KNAUF THERMAL LAMINATE

CODE T/E	THICKNESS (mm)	WIDTH (mm)	LENGTH (mm)	WEIGHT (per pallet - tonnes)	BOARDS (per pallet)	£ PRICE (per m ²)	£ PRICE (per board)
73717 0225	22	1200	2400	0.87	46	7.69	22.15
73717 1300	30	1200	2400	0.64	32	8.96	25.80
73717 2400	40	1200	2400	0.50	25	10.72	30.87

KNAUF THERMAL LAMINATE VAPOUR CHECK

CODE T/E	THICKNESS (mm)	WIDTH (mm)	LENGTH (mm)	WEIGHT (per pallet - tonnes)	BOARDS (per pallet)	£ PRICE (per m ²)	£ PRICE (per board)
73717 0226	22	1200	2400	0.87	46	9.09	26.48
73717 1301	30	1200	2400	0.64	32	10.40	29.95
73717 2405	40	1200	2400	0.5	25	12.12	34.91

KNAUF THERMAL LAMINATE PLUS

CODE T/E	THICKNESS (mm)	WIDTH (mm)	LENGTH (mm)	WEIGHT (per pallet - tonnes)	BOARDS (per pallet)	£ PRICE (per m ²)	£ PRICE (per board)
73723 0270	27	1200	2400	0.71	36	14.04	40.44
73723 2355	35	1200	2400	0.58	28	15.67	45.13
73723 2404	40	1200	2400	0.53	25	17.68	50.92
73723 2450	45	1200	2400	0.47	22	19.28	55.53
73723 3555	55	1200	2400	0.36	16	22.15	63.79

KNAUF PHENOLIC LAMINATE

CODE T/E	THICKNESS (mm)	WIDTH (mm)	LENGTH (mm)	WEIGHT (per pallet - tonnes)	BOARDS (per pallet)	£ PRICE (per m ²)	£ PRICE (per board)
73718 0050	50	1200	2400	0.46	20	27.42	78.97
73718 0600	60	1200	2400	0.37	16	35.12	101.15
73718 0650	65	1200	2400	0.35	15	38.77	111.66

BOARDS ALSO OFFERED:

KNAUF SAFEBOARD

AN ADDITIONAL WEIGHT LOADING FACTOR APPLIES TO DELIVERY CHARGES FOR LAMINATES. CALL YOUR LOCAL BRANCH FOR DETAILS.

Manufacturer direct delivery service charges as per manufacturer's current price list.
Price details available on application to your local branch.

ANCILLARIES & JOINTING PRODUCTS

KNAUF BONDING COMPOUND

CODE	SIZE	COVERAGE	NO. (per pallet)	£ PRICE (per bag)
A multi-purpose gypsum-based adhesive for use with Knauf metal furring channel and for direct bonding of all Knauf plasterboards and insulating laminates.				
73734 0495	25kg bag	4.6m ² /bag	60	9.50

KNAUF GYPSUM PARGE COAT

CODE	SIZE	COVERAGE	NO. (per pallet)	£ PRICE (per bag)
A gypsum-based compound specifically designed to seal masonry walls prior to direct bonding with Knauf plasterboards.				
73734 0450	25kg bag	4.25m ² /bag at a minimum thickness of 6mm	60	10.29

KNAUF JOINT FILLER

CODE	SIZE	COVERAGE	NO. (per pallet)	£ PRICE (per bag)
A gypsum-based compound for bedding joints by hand application.				
73734 1217	20kg bag	110m ² /bag	42	18.32

KNAUF JOINT CEMENT EASY SAND

CODE	SIZE	COVERAGE	NO. (per pallet)	£ PRICE (per bag)
A lightweight air-drying compound for bedding tapes and finishing joints by hand or machine.				
73734 1185	20kg bag	80m ² /bag for 2 coats of finish	42	33.72

KNAUF JOINT CEMENT LITE EASY SAND

CODE	SIZE	COVERAGE	NO. (per pallet)	£ PRICE (per bag)
A lightweight air-drying compound for bedding tapes and finishing joints by hand or machine.				
73734 1186	12.7L tub	40m ² /tub	48	27.19

KNAUF WALLBOARD PRIMER

CODE	SIZE	COVERAGE	NO. (per pallet)	£ PRICE (per bag)
A surface treatment to allow for paint and wallboard decoration by single coat application, and also to provide a vapour check by two coat application.				
73734 1400	12L tub	80m ² /tub	36	58.62

KNAUF JOINT TAPE AND FIBRE TAPE

CODE	SIZE	COVERAGE	NO. (per carton)	£ PRICE (per roll)
Joint tape - perforated white tape for reinforcing joints.				
Fibre tape - multi purpose self-adhesive tape for reinforcing joints and patch repairs to plasterboard.				
73734 3101	Joint tape	150m	1 roll/100m	10
73734 3250	Fibre tape	153m	1 roll/100m	12

KNAUF SEALANT

CODE	SIZE	COVERAGE	NO. (per pallet)	£ PRICE (per item)
An all purpose gun applied sealant for use with Knauf Drywall Systems.				
73734 3301	0.9L cartr.	30-40 Linear m/cartr. for 10mm bead	6	14.89

It's what you've been waiting for



**6mm
available
now**

AQUAPANEL®

Cement Board

6mm Floor Tile Underlay

For years you have trusted Aquapanel tile backer to look after your wall tiles

Now you can offer the same rock-solid protection to your floor tiles with new 6mm Aquapanel Floor Tile Underlay

- Same tough Portland cement construction
- Just as easy to score, snap and fix
- Still totally unaffected by water
- Now available as 6mm Aquapanel Floor Tile Underlay

Trust Aquapanel

Available now - call 08700 613700
for your FREE leaflet

KNAUF DRYWALL

ANCILLARIES & JOINTING PRODUCTS

KNAUF COVE

CODE	SIZE	NO. (per pack)	£ PRICE (per lm)
73735 0300	127mm wide x 3000 long	5	1.54
73735 0360	127mm wide x 3600 long	5	1.54
73735 1300	90mm wide x 3000 long	7	1.54

(Coving is shrink wrapped and therefore sold in full packs only.)

KNAUF COVE MITRES

CODE	WIDTH (mm)	NO. (per pack)	£ PRICE (per pack)
A reusable plastic tool to achieve accurate mitred corners.			
73735 2190	90	20	63.02
73735 2127	127	20	63.02

KNAUF COVE ADHESIVE

CODE	SIZE	COVERAGE (per bag)	NO. (per pallet)	£ PRICE (per bag)
73735 5105	5kg bag	18-241m	180	6.32

KNAUF MP FINISH

CODE	SIZE	COVERAGE (per bag)	NO. (per pallet)	£ PRICE (per bag)
A spray applied finish plaster suitable for plasterboards and fully cured sand and cement backgrounds.				
73730 0690	25kg bag	16-18 m ²	60	9.83

KNAUF MP75 PROJECTION PLASTER

CODE	SIZE	COVERAGE (per bag)	NO. (per pallet)	£ PRICE (per bag)
A machine applied one coat plaster. Can be applied up to 20mm thickness in one application.				
73734 0750	25kg bag	2.5 m ²	48	10.20

KNAUF UNIVERSAL PLASTER

CODE	SIZE	COVERAGE (per bag)	NO. (per pallet)	£ PRICE (per bag)
73730 0150	25kg bag	2.25m ² per 25kg	50	9.66

KNAUF UNIVERSAL BOARD FINISH

CODE	SIZE	COVERAGE (per bag)	NO. (per pallet)	£ PRICE (per bag)
A two coat high performance finish plaster for application to the ivory face of plasterboards.				
73730 0255	25kg bag	14 m ²	60	6.32

KNAUF PATCHWALL 45 PLASTER

CODE	SIZE	COVERAGE (per bag)	NO. (per pallet)	£ PRICE (per bag/tub)
A patching plaster for hand application with a 45 minute set.				
73730 0675	10kg bag	0.8 m ²	100	8.89

KNAUF READY MIX

CODE	DESCRIPTION	SIZE	NO. (per pallet)	COVERAGE	£ PRICE (per bag)
73730 0400	Plano	25 kg	40	9.5m ² per 25kg at 1.5mm thickness	24.23
73730 0672	Deco	25 kg	40	18m ² per 25kg at 1mm thickness	24.23
73730 0673	Deco Plus	25 kg	40	18m ² per 25kg at 1mm thickness	25.78
73730 0500	Airless	25 kg	40	20m ² per 25kg at 1mm thickness	27.24

KNAUF C STUDS

CODE	GAUGE	SIZE / WEB	LENGTH (mm)	LENGTHS (per pack)	£ PRICE (per pack)	£ PRICE (per lm)
73732 0011	0.55	50	2400	10	41.80	1.74
73732 0022	0.55	50	2700	10	47.00	1.74
73732 0033	0.55	50	3000	10	52.20	1.74
73732 0044	0.55	50	3600	10	62.70	1.74
73732 0053	0.55	60	3000	10	73.50	2.45
73732 0055	0.55	60	3600	10	88.20	2.45
73732 0111	0.55	70	2400	10	54.00	2.25
73732 0121	0.55	70	2700	10	60.80	2.25
73732 0133	0.55	70	3000	10	67.50	2.25
73732 0144	0.55	70	3600	10	81.00	2.25
73732 0148	0.55	70	4200	10	94.50	2.25
73732 0418	0.55	146	2700	10	113.20	4.19
73732 0423	0.55	146	3000	10	125.70	4.19
73732 0413	0.55	146	3600	10	150.90	4.19
73732 0426	0.55	146	4200	10	176.00	4.19
73732 0143	0.7	70	3600	10	165.30	4.59
73732 0149	0.7	70	4200	10	192.80	4.59
73732 0214	0.7	92	3600	10	183.30	5.09
73732 0216	0.7	92	4200	10	213.80	5.09
73732 0431	0.7	146	4200	10	255.40	6.08

KNAUF ACOUSTIC C STUDS

CODE	GAUGE	SIZE / WEB	LENGTH (mm)	LENGTHS (per pack)	£ PRICE (per pack)	£ PRICE (per lm)
73732 4500	0.6	50	2400	10	67.50	2.81
73732 4501			2700	10	75.90	2.81
73732 4502			3000	10	84.30	2.81
73732 4508	0.6	70	2400	10	94.80	3.95
73732 4505			3000	10	118.50	3.95
73732 4506			3600	10	142.20	3.95
73732 4507			4200	10	165.90	3.95

KNAUF I STUDS

CODE	GAUGE	SIZE / WEB	LENGTH (mm)	LENGTHS (per pack)	£ PRICE (per pack)	£ PRICE (per lm)
73732 1022	0.55	50	2700	10	115.60	4.28
73732 1030	0.55	50	3000	10	128.40	4.28
73732 1060	0.55	60	3600	10	152.30	4.23
73732 1064	0.55	60	4200	10	177.70	4.23
73732 1070	0.7	70	3600	10	208.10	5.78
73732 1074	0.7	70	4200	10	242.80	5.78
73732 1095	0.9	92	5000	10	313.00	6.26
73732 1096	0.9	92	6000	10	375.60	6.26
73732 1466	0.9	146	6000	10	582.00	9.70

METAL SECTIONS

KNAUF U CHANNEL

CODE	GAUGE	SIZE / WEB	LENGTH (mm)	LENGTHS (per pack)	£ PRICE (per pack)	£ PRICE (per lm)
73732 2015	0.55	52	3000	10	52.80	1.76
73732 2123		62	3000	10	61.20	2.04
73732 2132		72	3000	10	62.10	2.07
73732 2153		94	3000	10	80.70	2.69
73732 2183		148	3000	10	99.60	3.32

KNAUF DEEP FLANGE U CHANNEL - 50MM

CODE	GAUGE	SIZE / WEB	LENGTH (mm)	LENGTHS (per pack)	£ PRICE (per pack)	£ PRICE (per lm)
73732 2207	0.6	52	3000	10	101.40	3.38
73732 2206		72	3000	10	110.70	3.69

KNAUF DEEP FLANGE U CHANNEL - 70MM

CODE	GAUGE	SIZE / WEB	LENGTH (mm)	LENGTHS (per pack)	£ PRICE (per pack)	£ PRICE (per lm)
73732 2198	0.7	52	3000	10	162.30	5.41
73732 2200	0.7	62	3000	10	167.70	5.59
73732 2204	0.7	72	3000	10	172.80	5.76
73732 2210	0.7	94	3000	10	202.50	6.75
73732 2220	0.7	148	3000	10	232.20	7.74

KNAUF CEILING & WALL LINING SYSTEMS

CODE	GAUGE	SIZE / WEB	LENGTH (mm)	LENGTHS (per pack)	£ PRICE (per pack)	£ PRICE (per lm)
73732 5202	Knauf C Channel	47 Webb x 17 Flange	2400	10	56.20	2.33
73732 5206		47 Webb x 17 Flange	2700	10	63.20	2.33
73732 5180		47 Webb x 17 Flange	3000	10	70.20	2.33
73732 5254		47 Webb x 17 Flange	4000	10	93.60	2.33
73732 6150	Knauf Channel Intersection Connector	54 Webb x 12 Flange		100/pack	82.94	
73732 6170	Knauf "C" Channel Connector	45 Webb x 15 Flange		100/pack	74.20	
73732 6110	Knauf Universal Bracket	46 width x 127 Flange		100/pack	121.82	
73732 9260	Knauf Soffit Cleat			100/pack	24.94	
73758 0100	Knauf MF Ceiling Channel	0.55	3600	50	351.00	1.95
73758 0200	Knauf MF Perimeter Channel	0.5	3600	20	94.40	1.31
73758 0300	Knauf MF Primary Support Channel	0.8	3600	20	149.80	2.08
73758 0800	Knauf Strap Hanger	0.55	2500	1	16.69	
73758 0400	Knauf MF Connecting Clip			200/pack	82.69	
73758 0700	Knauf MF Nut and Bolt			200/pack	25.05	

KNAUF C-T STUD

CODE	GAUGE	SIZE / WEB	LENGTH (mm)	LENGTHS (per pack)	£ PRICE (per pack)	£ PRICE (per lm)
73732 0511	0.92	60	3000	10	300.00	10.00
73732 0512			4500	10	450.00	10.00
73732 0704		92	4500	10	537.30	11.94
73732 0705			5500	10	656.70	11.94
73732 0805		146	5500	10	824.45	14.99
73732 0806			6500	10	974.35	14.99

KNAUF CORE BOARD CHANNEL

CODE	GAUGE	SIZE / WEB	LENGTH (mm)	LENGTHS (per pack)	£ PRICE (per pack)	£ PRICE (per lm)
73732 1900	0.55	20	3600	10	102.60	2.85

KNAUF J CHANNEL

CODE	THICKNESS (mm)	SIZE / WEB	LENGTH (mm)	LENGTHS (per pack)	£ PRICE (per pack)	£ PRICE (per lm)
73732 7230	0.92	62	3000	10	225.00	7.50
73732 7245			4500	10	337.50	7.50
73732 7292		94	4500	10	400.95	8.91
73732 7294			5500	10	490.05	8.91
73732 7348		148	5500	10	640.75	11.65
73732 7354			6500	10	757.25	11.65

OTHER KNAUF DRYWALL PRODUCTS ARE AVAILABLE

STANDARD BOARDS

LAFARGE GTEC STANDARD BOARD								
CODE T/E	CODE S/E	THICKNESS (mm)	WIDTH (mm)	LENGTH (mm)	WEIGHT (per pallet - tonnes)	BOARDS (per pallet)	£ PRICE (per m ²)	£ PRICE (per board)
73901 0566	73901 056X	9.5	900	1800	1.02	100	6.64	10.76
73901 0649			900	2400	1.36	100	6.64	14.34
73901 112X	73901 1108		1200	2400	1.67	92	5.82	16.76
73901 1207			1200	2700	1.88	92	5.82	18.86
73901 4180	73901 4190	12.5	900	1800	1.08	80	6.61	10.71
73901 4241	73901 4240		900	2400	1.44	80	6.61	14.28
73901 0235			1200	2350	1.70	72	5.77	16.27
73901 5120	73901 5109		1200	2400	1.73	72	5.77	16.62
73901 5170			1200	2500	1.80	72	5.77	17.31
73901 520X	73901 5208		1200	2700	1.95	72	5.77	18.69
73901 5213	73901 5214		1200	3000	1.80	60	5.77	20.77
73901 6009		15	900	1800	0.99	60	8.19	13.27
73901 6106	73901 6105		900	2400	1.32	60	8.19	17.69
73901 6155	73901 6153		1200	2400	1.47	50	6.95	20.02
73901 6168			1200	2700	1.65	50	6.95	22.52
73901 6173			1200	3000	1.84	50	6.95	25.02

LAFARGE GTEC PLANK								
CODE T/E	CODE S/E	THICKNESS (mm)	WIDTH (mm)	LENGTH (mm)	WEIGHT (per pallet - tonnes)	BOARDS (per pallet)	£ PRICE (per m ²)	£ PRICE (per board)
73911 2200	73911 2199	19	600	2400	1.60	80	12.49	17.99

PERFORMANCE BOARDS

LAFARGE GTEC VAPOUR BOARD								
CODE T/E	CODE S/E	THICKNESS (mm)	WIDTH (mm)	LENGTH (mm)	WEIGHT (per pallet - tonnes)	BOARDS (per pallet)	£ PRICE (per m ²)	£ PRICE (per board)
73907 5094	73907 5096	9.5	1200	2400	1.67	92	8.59	24.74
	73907 5016	12.5	900	1800	1.08	80	9.60	15.55
73907 5120	73907 5131		1200	2400	1.73	72	8.54	24.60
73907 5151			1200	2700	1.95	72	8.54	27.67
73907 5161			1200	3000	1.80	60	8.54	30.74
73907 6154			1200	2400	1.47	50	9.81	28.25

LAFARGE GTEC MOISTURE BOARD								
CODE T/E	CODE S/E	THICKNESS (mm)	WIDTH (mm)	LENGTH (mm)	WEIGHT (per pallet - tonnes)	BOARDS (per pallet)	£ PRICE (per m ²)	£ PRICE (per board)
73905 5120		12.5	1200	2400	1.97	72	9.20	26.50
73905 5127			1200	2700	2.22	72	9.20	29.81
73905 5130			1200	3000	2.05	60	9.20	33.12
73905 5155		15	1200	2400	1.47	50	11.04	31.80

LAFARGE GTEC FIRE BOARD								
CODE T/E	CODE S/E	THICKNESS (mm)	WIDTH (mm)	LENGTH (mm)	WEIGHT (per pallet - tonnes)	BOARDS (per pallet)	£ PRICE (per m ²)	£ PRICE (per board)
73906 5016	73906 5017	12.5	900	1800	1.36	80	8.69	14.08
73906 5120	73906 5125		1200	2400	1.81	60	7.71	22.20
73906 5116			1200	2700	2.04	60	7.71	24.98
73906 5127			1200	3000	2.27	60	7.71	27.76
73906 5190		15	900	1800	1.32	60	10.34	16.75
73906 5129			1200	2400	1.80	50	9.10	26.21
73906 5131			1200	2700	2.03	50	9.10	29.48
73906 5135			1200	3000	2.25	50	9.10	32.76

LAFARGE GTEC FIRE V BOARD								
CODE T/E	CODE S/E	THICKNESS (mm)	WIDTH (mm)	LENGTH (mm)	WEIGHT (per pallet - tonnes)	BOARDS (per pallet)	£ PRICE (per m ²)	£ PRICE (per board)
73921 5255		12.5	1200	2400	1.84	60	9.88	28.45
73921 6154		15	1200	2400	1.80	50	11.32	32.60

LAFARGE GTEC FIRE CORE BOARD								
CODE T/E	CODE S/E	THICKNESS (mm)	WIDTH (mm)	LENGTH (mm)	WEIGHT (per pallet - tonnes)	BOARDS (per pallet)	£ PRICE (per m ²)	£ PRICE (per board)
	73908 1255	25	600	3000	2.32	60	24.41	43.94

PLASTERBOARDS

PERFORMANCE BOARDS - CONTINUED

LAFARGE GTEC DB BOARD

CODE T/E	CODE S/E	THICKNESS (mm)	WIDTH (mm)	LENGTH (mm)	WEIGHT (per pallet - tonnes)	BOARDS (per pallet)	£ PRICE (per m ²)	£ PRICE (per board)
73928 0125		12.5	1200	2400	2.05	60	9.16	26.38
73928 0127			1200	2700	2.30	60	9.16	29.68
73928 0133			1200	3000	2.12	50	9.16	32.98
73928 0155		15	1200	2400	1.94	50	11.01	31.71
73928 0157			1200	2700	2.19	50	11.01	35.67
73928 0160			1200	3000	1.95	40	11.01	39.64

LAFARGE GTEC ACOUSTIC HOMESPAN BOARD

CODE T/E	CODE S/E	THICKNESS (mm)	WIDTH (mm)	LENGTH (mm)	WEIGHT (per pallet - tonnes)	BOARDS (per pallet)	£ PRICE (per m ²)	£ PRICE (per board)
73932 0150		15	900	1800	1.31	60	9.72	15.75
73932 0151	73932 1151		900	2400	1.74	60	9.72	21.00
73932 0153			900	2500	1.81	60	9.72	21.87
73932 0152	73932 0154		900	2700	1.95	60	9.72	23.62
73932 2151		15 MR	900	2400	17.4	60	14.10	30.46
73932 2700			900	2700	1.95	60	14.10	34.26

LAFARGE GTEC THERMAL BOARD

CODE T/E	THICKNESS (mm)	WIDTH (mm)	LENGTH (mm)	WEIGHT (per pallet - tonnes)	BOARDS (per pallet)	£ PRICE (per m ²)	£ PRICE (per board)
73916 2225	22	1200	2400	0.89	30	8.94	25.75
73916 2305	30	1200	2400	0.90	30	9.84	28.34
73916 2400	40	1200	2400	0.61	20	11.25	32.40
73916 2504	50	1200	2400	0.60	18	13.24	38.13

LAFARGE GTEC THERMAL XP BOARD

CODE T/E	THICKNESS (mm)	WIDTH (mm)	LENGTH (mm)	WEIGHT (per pallet - tonnes)	BOARDS (per pallet)	£ PRICE (per m ²)	£ PRICE (per board)
73915 5287	27	1200	2400	0.88	30	14.19	40.87
73915 5355	35	1200	2400	0.79	25	15.99	46.05
73915 5555	55	1200	2400	0.58	18	24.21	69.72

LAFARGE GTEC THERMAL K BOARD

CODE T/E	THICKNESS (mm)	WIDTH (mm)	LENGTH (mm)	WEIGHT (per pallet - tonnes)	BOARDS (per pallet)	£ PRICE (per m ²)	£ PRICE (per board)
73924 0305	30	1200	2400	0.63	30	29.78	85.77
73924 0400	40	1200	2400	0.44	20	33.41	96.22
73924 0504	50	1200	2400	0.41	18	36.49	105.09
73924 0600	60	1200	2400	0.39	16	47.17	135.84
73924 0700	70	1200	2400	0.36	14	50.89	146.56

Lafarge GTEC Thermal K is ivory faced 9.5mm Lafarge tapered edge wallboard bonded to phenolic foam to give ultimate performance. A Vapourcheck barrier is provided on all boards as standard, inclusive in Thermal K price.

SPECIALIST BOARDS

LAFARGE GTEC AQUA BOARD

CODE T/E	CODE S/E	THICKNESS (mm)	WIDTH (mm)	LENGTH (mm)	WEIGHT (per pallet - tonnes)	BOARDS (per pallet)	£ PRICE (per m ²)	£ PRICE (per board)
73938 0850		12.5	1200	850*	0.63	52	38.92	112.09
73938 2400			1200	2400*	1.65	52	38.92	112.09
73938 2700			1200	2700	1.83	52	38.92	126.10
73938 5150		15	1200	2400	1.60	40	48.04	138.36

* Half pallets available on request

LAFARGE GTEC MEGADECO BOARD

CODE T/E	THICKNESS (mm)	WIDTH (mm)	LENGTH (mm)	WEIGHT (per pallet - tonnes)	BOARDS (per pallet)	£ PRICE (per m ²)	£ PRICE (per board)
73919 1244	12.5	1200	2400	1.9	60	11.07	31.88
73919 1274		1200	2700	2.14	60	11.07	35.87
73919 1280		1200	3000	2.38	60	11.07	39.85
73919 0154	15	1200	2400	1.89	50	13.86	39.92
73919 1154		1200	2700	2.13	50	13.86	44.91
73919 0158		1200	3000	2.36	50	13.86	49.90

BOARDS ALSO OFFERED:

LAFARGE LATH, BASE BOARD, VAPOUR BASE BOARD, CONTOUR BOARD, FIRE MR BOARD, E BOARD, PREGYBEL, HYDRODECO.

AN ADDITIONAL WEIGHT LOADING FACTOR APPLIES TO DELIVERY CHARGES FOR LAMINATES. CALL YOUR LOCAL BRANCH FOR DETAILS.

Manufacturer direct delivery service charges as per manufacturer's current price list.
Price details available on application to your local branch.

GTEC[®] Aqua Board

THE ULTIMATE WET AREA BACKING BOARD
...FOR WET AND HIGH HUMIDITY APPLICATIONS



MOULD &
FUNGUS
RESISTANT



SCORE & SNAP



EASY TO FINISH



TRIED & TESTED



GTEC[®]

PLASTERBOARD SOLUTIONS

GTEC Aqua Board is the UK's first gypsum based board for use in high humidity and wet area applications. Its gypsum based core makes it easier to handle, cut and fix, unlike traditional cementitious boards. This unique board can also be used for external applications as a sheathing board for steel frame EIFS systems.

- Ideal for swimming pools, saunas and wet rooms
- BBA Certification
- An ideal tile backing board
- Can be left on site, uncovered, for up to 6 months
- Complete protection from mould & fungus



LAFARGE
bringing materials to *life*

Find out more at www.lafarge-aquaboard.com

ADHESIVES & FINISHING PRODUCTS

LAFARGE GTEC JOINT FILLER XTRA

CODE	BAG SIZE (kg)	BAGS (per pallet)	PALLET WEIGHT (tonnes)	£ PRICE (per bag)
Gypsum based jointing compound with 90 minute setting time for bedding tapes by hand application. Coverage Guide: 25m ² bedding & filling only, 37m ² bedding coat only.				
73909 4100	12.5	80	1.06	11.44

LAFARGE GTEC ALLSET XTRA

CODE	BAG SIZE (kg)	BAGS (per pallet)	PALLET WEIGHT (tonnes)	£ PRICE (per bag)
Combined setting and air-drying compound, allows a single compound to be used for bedding all tapes and finishing. Can be used in a 2-stage application. Coverage Guide: 25m ² full taping operation, 47m ² bedding coat only.				
73997 8200	10	80	0.86	17.58

LAFARGE GTEC JOINT CEMENT XTRA

CODE	BAG SIZE (kg)	BAGS (per pallet)	PALLET WEIGHT (tonnes)	£ PRICE (per bag)
Light-weight, air-drying joint cement offering superior coverage and easy sanding. Can be used for bedding tapes and finishing joints in a 2-stage application. Also suitable for machine application. Coverage guide: 64m ² full taping operation, 175m ² finishing coat only.				
73997 8202	22.5	40	0.9	32.57

LAFARGE GTEC SMARTMIX XTRA

CODE	BUCKET SIZE (kg)	BUCKETS (per pallet)	PALLET WEIGHT (tonnes)	£ PRICE (per bucket)
Ready-mixed, light-weight compound offering superior coverage and easy sanding. Can be used for bedding tapes and finishing joints in a 2-stage application. Ideal for machine application. Coverage guide: 50m ² full taping operation, 135m ² finishing coat only.				
73997 8204	20	30	0.62	38.14

LAFARGE GTEC UNIVERSAL BONDING COMPOUND

CODE	BAG SIZE (kg)	BAGS (per pallet)	PALLET WEIGHT (tonnes)	£ PRICE (per bag)
Gypsum based compound for direct bonding plasterboard to walls or bonding CORMET metal furring to walls. Coverage guide: 4m ² external walls, 8m ² internal walls, 13m ² laminated partitions				
73997 1202	25	56	1.44	9.63

LAFARGE GTEC WALL LINING ADHESIVE

CODE	BUCKET SIZE (ltr)	BUCKETS (per pallet)	PALLET WEIGHT (tonnes)	£ PRICE (per bucket)
For bonding plasterboard to metal, wood, plasterboard and other suitable backgrounds. Coverage Guide: 50m ²				
73997 1215	5	100	0.5	35.93

LAFARGE GTEC ECOAT

CODE	BAG SIZE (kg)	BAGS (per pallet)	PALLET WEIGHT (tonnes)	£ PRICE (per bag)
A Gypsum based acoustic render mix for use on party walls prior to direct bonding. Coverage Guide: 50m ²				
73997 0265	25	50	1.29	13.03

LAFARGE GTEC TRADE JOINT FILLER

CODE	BAG SIZE (kg)	BAGS (per pallet)	PALLET WEIGHT (tonnes)	COVERAGE	£ PRICE (per bag)
73909 7120	12.5	80	1.06	25m ² bedding & filling, 37m ² bedding only	10.26

LAFARGE GTEC TRADE JOINT CEMENT

CODE	BAG SIZE (kg)	BAGS (per pallet)	PALLET WEIGHT (tonnes)	COVERAGE	£ PRICE (per bag)
73909 7140	25	40	1.06	55m ² full taping, 165m ² finishing only	27.32

LAFARGE GTEC TRADE READY MIX

CODE	BUCKET SIZE (kg)	BUCKETS (per pallet)	PALLET WEIGHT (tonnes)	COVERAGE	£ PRICE (per bucket)
73909 7150	20	30	0.62	45m ² full taping, 120m ² finishing only	25.96

LAFARGE GTEC DECO FILLER

CODE	BUCKET SIZE (kg)	BUCKETS (per pallet)	PALLET WEIGHT (tonnes)	COVERAGE	£ PRICE (per bucket)
73909 8125	12.5kg	1.06	80	25m ² per bucket	11.72

LAFARGE GTEC DECO JOINT CEMENT

CODE	BUCKET SIZE (kg)	BUCKETS (per pallet)	PALLET WEIGHT (tonnes)	COVERAGE	£ PRICE (per bucket)
73909 8251	20kg	0.62	30	50m ² full taping, 135m ² finishing coat only	38.27

LAFARGE GTEC DECO MACHINE

CODE	BUCKET SIZE (kg)	BUCKETS (per pallet)	PALLET WEIGHT (tonnes)	COVERAGE	£ PRICE (per bucket)
73909 8252	20kg	0.62	30	50m ² full taping, 135m ² finishing coat only	38.27

LAFARGE GTEC AQUAMIX

CODE	BUCKET SIZE (kg)	BUCKETS (per pallet)	PALLET WEIGHT (tonnes)	COVERAGE	£ PRICE (per bucket)
73997 0035	5kg	0.64	96		18.32
73997 0040	20kg	0.62	30	50m ² full taping, 135m ² finishing coat only	50.50

ADHESIVES & FINISHING PRODUCTS

29

LAFARGE

LAFARGE GTEC SEALERS

CODE	BUCKET SIZE (litre)	BUCKETS (per pallet)	PALLET WEIGHT (tonnes)	£ PRICE (per bucket)
Universal Sealer For use on wallboard prior to paint and wallpaper application. Improved whiteness and covering power. Does not provide a vapour control layer. Coverage Guide: 100m ² One Coat.				
73997 0310	10	48	0.70	47.63
Drywall Sealer Ivory, pre decoration coat for plasterboard. Can also provide a control layer, if two coats are applied to the wallboard. Coverage Guide: 100m ² , 70m ² two coats.				
73997 1060	10	48	0.70	60.91

LAFARGE GTEC TAPES

CODE	PRODUCT	LENGTH (per roll)	COVERAGE	NO. (per box)	£ PRICE (per roll)
73997 8012	Joint tape	150m	1 roll/100m ² brd.	10	5.82
73997 8025	Patching tape	90m	As required	12	9.22
73997 8015	Flex tape	33m	As required	6	19.52

LAFARGE GTEC AQUASTRIP

CODE	ROLL SIZE (m)	THICKNESS (mm)	ROLLS (per pallet)	£ PRICE (per roll)
73938 7000	50	0.25	400	63.01

LAFARGE GTEC COVE

CODE	SIZE (mm)	LENGTH (mm)	LENGTHS (per pack)	£ PRICE (per lm)
73912 0105	90	3000	7	1.57
73912 1203	120	3000	5	1.57
73912 1204		3600	5	1.57
73912 1206		4200	5	1.57

LAFARGE GTEC COVE

CODE	BAG SIZE (kg)	PACK SIZE	BAGS (per pallet)	£ PRICE (per bag)
73997 1252	12.5KG	1 bag	80	12.71
73997 1255	5KG	5 bags	200	6.75

LAFARGE GTEC C STUDS

CODE	GAUGE	WIDTH (mm)	LENGTH (mm)	LENGTHS (per pack)	£ PRICE (per pack)	£ PRICE (per lm)
73991 1440	RX	44	2400	10	94.80	3.95
73994 4500		50	2400	10	72.24	3.01
73994 4501		50	2500	10	75.25	3.01
73994 4502		50	2700	10	81.27	3.01
73994 4503		50	3000	10	90.30	3.01
73994 4505		50	3600	10	108.36	3.01
73994 4604		60	3000	10	111.60	3.72
73994 4700		70	2400	10	92.40	3.85
73994 4702		70	2700	10	103.95	3.85
73994 4703		70	3000	10	115.50	3.85
73994 4704		70	3600	10	138.60	3.85
73994 4705		70	4200	10	161.70	3.85
73994 4706		70	4800	10	184.80	3.85
73994 4860		90	3000	10	150.00	5.00
73994 4861		90	3600	10	180.00	5.00
73994 4862		90	4200	10	210.00	5.00
73994 4865		146	3000	10	170.70	5.69
73994 4866		146	3600	10	204.84	5.69
73994 4867		146	4200	10	238.98	5.69
73994 4750	B	70	3600	10	228.60	6.35
73994 4756		70	4200	10	266.70	6.35
73994 4862		90	4200	10	210.00	5.00
73994 4875		146	3600	10	303.48	8.43
73994 4873		146	4800	10	404.63	8.43
73994 4871		146	6000	10	505.80	8.43
73994 4877	W	90	4800	10	594.24	12.38
73994 4880		90	6000	10	742.80	12.38
73994 4780	Y	70	4800	10	292.32	6.09
73994 4762		90	4800	10	417.12	8.69
73994 4878		146	6000	10	567.00	9.45

Metal must be ordered in pack quantities.

LAFARGE GTEC U TRACK

CODE	GAUGE	WIDTH (mm)	LENGTH (mm)	LENGTHS (per pack)	£ PRICE (per pack)	£ PRICE (per lm)
73992 8005	RX	45	2400	10	56.40	2.35
73994 5033		52	3000	10	85.20	2.84
73994 5025		62	3000	10	94.20	3.14
73994 5035		72	3000	10	97.80	3.26
73994 5040		92	3000	10	141.00	4.70
73994 5052		148	3000	10	164.70	5.49

LAFARGE GTEC I STUDS

CODE	GAUGE	WIDTH (mm)	LENGTH (mm)	LENGTHS (per pack)	£ PRICE (per pack)	£ PRICE (per lm)
73994 4629	RX	50	3000	10	177.60	5.92
73994 4621	B	60	3000	10	217.50	7.25
73994 4641		60	3600	10	261.00	7.25
73994 4714		70	3600	10	289.80	8.05
73994 4715		70	4200	10	338.10	8.05
73994 4736		90	6000	10	534.00	8.90

LAFARGE GTEC ACOUSTIC HOMESPAN SYSTEM METAL

CODE	GAUGE	WIDTH (mm)	LENGTH (mm)	LENGTHS (per pack)	£ PRICE (per pack)	£ PRICE (per lm)
C Stud						
73991 0440	RX	44	2400	10	104.88	4.37
73991 0445			2700	10	117.99	4.37
73991 0500		50	2400	10	104.88	4.37
Starter Stud						
73991 1440	RX	44	2400	10	94.80	3.95
73991 1500		50	2400	10	102.48	4.27

LAFARGE GTEC OMEGA ACOUSTIC STUD

CODE	GAUGE	WIDTH (mm)	LENGTH (mm)	LENGTHS (per pack)	£ PRICE (per pack)	£ PRICE (per lm)
73994 3673	RX	70	3600	10	176.76	4.91
73994 3700		90	4200	10	259.98	6.19
73994 3900		146	3000	2	70.38	11.73

LAFARGE GTEC CH STUD

CODE	GAUGE	WIDTH (mm)	LENGTH (mm)	LENGTHS (per pack)	£ PRICE (per pack)	£ PRICE (per lm)
73994 5106	B	60	3000	10	336.00	11.20
73994 5130		60	4800	10	537.60	11.20
73994 5127		90	6600	10	855.36	12.96
73994 5114		146	6000	10	948.60	15.81

LAFARGE GTEC U TRACK DEEP FLANGE

CODE	GAUGE	WIDTH (mm)	LENGTH (mm)	LENGTHS (per pack)	£ PRICE (per pack)	£ PRICE (per lm)
73994 5054	B	52	3000	10	212.70	7.09
73994 5056		62	3000	10	245.70	8.19
73994 5057		72	3000	10	252.30	8.41
73994 5058		92	3000	10	308.40	10.28
73994 5053		148	3000	10	341.40	11.38
73994 5034	Y	52	3000	10	280.80	9.36

LAFARGE GTEC U TRACK EXTRA DEEP FLANGE

CODE	GAUGE	WIDTH (mm)	LENGTH (mm)	LENGTHS (per pack)	£ PRICE (per pack)	£ PRICE (per lm)
73994 5075	B	72	3000	10	349.80	11.66
73994 5077	W	92	3000	10	445.50	14.85
73994 5085		148	3000	10	552.00	18.40

LAFARGE GTEC J TRACK

CODE	GAUGE	WIDTH (mm)	LENGTH (mm)	LENGTHS (per pack)	£ PRICE (per pack)	£ PRICE (per lm)
73994 5172	B	62	3000	10	195.00	6.50
73994 5174		92	3000	10	227.10	7.57
73994 5175		148	3000	10	315.60	10.52

LAFARGE GTEC MF SUSPENDED CEILINGS SYSTEM

CODE	PRODUCT	THICKNESS (mm)	LENGTH (lm)	£ PRICE (per roll)
73994 2107	Strap Hanger	0.55	25	26.69

CODE	PRODUCT	NO. (per pack)	£ PRICE (per pack)
73994 2115	Connecting Clip	200	111.40
73994 2109	Soffit Cleat	200	75.80

CODE	PRODUCT	THICKNESS (mm)	LENGTH (mm)	PACKS (per pallet)	LENGTHS (per pack)	WEIGHT PER LM (kg)	£ PRICE (per lm)
73994 2116	Ceiling Channel	0.55	3600	20	10	0.47	3.01
73994 2104	Primary Channel	0.80	3600	30	10	0.45	3.14
73994 5034	Heavy Gauge Primary Channel	1.20	3000	30	10	1.00	9.36
73994 2103	Edge Channel	0.55	3600	30	10	0.28	2.18
73994 4905	Fixing Channel	0.9	2400	30	10	0.68	4.16

OTHER LAFARGE PRODUCTS ARE AVAILABLE

SPEEDLINE STUD AND TRACK SYSTEM

CODE	DESCRIPTION	LENGTH (mm)	LENGTHS (per pack)	REFERENCE	£ PRICE (per length)	£ PRICE (per lm)
41591 0483	48mm C Stud	2400	10	PS48	3.24	1.35
41591 0484		2700	10		3.65	1.35
41591 0485		3000	10		4.05	1.35
41591 0486		3600	10		4.86	1.35
41591 0555	50mm C Stud	2400	10	PS50	3.29	1.37
41591 0556		2700	10		3.70	1.37
41591 0557		3000	10		4.11	1.37
41591 0558		3600	10		4.93	1.37
41591 0600	60mm C Stud	2400	10	PS60	4.66	1.96
41591 0605		2700	10		5.29	1.96
41591 0610		3000	10		5.88	1.96
41591 0615		3600	10		7.06	1.96
41591 0701	70mm C Stud	2400	10	PS70	3.89	1.62
41591 0702		2700	10		4.37	1.62
41591 0705		3000	10		4.86	1.62
41591 0707		3600	10		5.83	1.62
41591 0708		4200	10		6.80	1.62
41591 0793	92mm C Stud	3600	10	PS92	8.78	2.44
41591 0794		4200	10		10.25	2.44
41591 1460	146mm C Stud	3600	8	PS146	9.79	2.72
41591 1462		4200	8		11.42	2.72
41591 1465		5000	8		13.60	2.72
41591 1466		6000	8		16.32	2.72
41591 0863	60mm I Stud 0.6mm	3600	10	PI60	13.25	3.68
41591 0864		4200	10		15.46	3.68
41591 0873	70mm I Stud 0.7mm	3600	10	PI70	15.05	4.18
41591 0874		4200	10		17.56	4.18
41591 0893	92mm I Stud 0.9mm	3600	5	PI92	18.50	5.14
41591 0895		5000	5		25.70	5.14
41591 0896		6000	5		30.84	5.14
41591 0903	146mm I Stud 0.9mm	3600	5	PI146	21.31	5.92
41591 0905		5000	5		29.60	5.92
41591 0906		6000	5		35.52	5.92
41591 0500	50mm Track	3000	10	PT50	3.45	1.15
41591 0523	52mm Track	3000	10	PT52	3.51	1.17
41591 2452	52mm Deep Track (32mm leg)	3000	10	PDT52	4.08	1.36
41591 2453	52mm Extra Deep Track (50mm leg)	3000	10	PEDT52	9.06	3.02
41591 2460	62mm Extra Deep Track (50mm leg)	3000	10	PEDT62	9.93	3.31
41591 0720	72mm Track	3000	10	PT72	3.96	1.32
41591 2473	72mm Deep Track (32mm leg)	3000	10	PDT72	4.20	1.40
41591 2454	72mm Extra Deep Track (50mm leg)	3000	10	PEDT72	9.45	3.15
41591 2474	72mm Long Leg Track (70mm leg)	3000	10	PXDT72	13.83	4.61
41591 2462	94mm Extra Deep Track (50mm leg)	3000	10	PEDT94	12.75	4.25
41591 2465	94mm Long Leg Track (70mm leg)	3000	10	PXDT94	15.63	5.21
41591 1483	148mm Track	3000	30	PT148	7.41	2.47
41591 2483	148mm Deep Track	3000	30	PDT148	9.18	3.06
41591 2503	148mm Long Leg Track	2000	10	PXDT148	17.67	5.89
41591 7050	Flat Bracing Strip 96 x 0.6	2400	20	FS	4.75	1.98
41591 3242	Partition Brace	2400	20	PB	5.33	2.22

SPEEDLINE ACOUSTIC STUD

CODE	DESCRIPTION	LENGTH (mm)	LENGTHS (per pack)	REFERENCE	£ PRICE (per length)	£ PRICE (per lm)
41591 1000	70mm Acoustic stud	2700	10	AS70	8.40	3.11
41591 1050		3000	10		9.33	3.11
41591 1100		3600	10		11.20	3.11
41591 1150		4200	10		13.06	3.11
41591 1200	92mm Acoustic stud	3600	10	AS92	12.28	3.41
41591 1250		4200	10		14.32	3.41

SPEEDLINE WALL FURRING

CODE	DESCRIPTION	LENGTH (mm)	LENGTHS (per pack)	REFERENCE	£ PRICE (per length)	£ PRICE (per lm)
41591 3551	Wall Furring Section	2100	10	WF559	2.90	1.38
41591 3550		2800	10		3.86	1.38

METAL COMPONENTS

33

SPEEDLINE

SPEEDLINE METAL FURRING SYSTEM

CODE	DESCRIPTION	LENGTH (mm)	LENGTHS (per pack)	REFERENCE	£ PRICE (per length)	£ PRICE (per lm)
41592 0100	50mm Ceiling Furring	3600	250	SMF5	4.64	1.29
41592 0155	Perimeter Channel	3600	10	SMF6A	3.31	0.92
41592 0200	Primary Channel	3600	10	SMF7	4.57	1.27
41592 1102	Pre-Formed Clips	-	200	MF9		33.21
41592 1080	Hanger Strap	25m coil	-	MF8		18.86
41592 2000	Acoustic Hanger	35mm	100	AAH01B		414.54
41592 2001	Acoustic Hanger	70mm	100	AAH02B		461.66

SPEEDLINE WALL/CEILING LINER SYSTEM

CODE	DESCRIPTION	LENGTH (mm)	LENGTHS (per pack)	REFERENCE	£ PRICE (per length)	£ PRICE (per lm)
41591 3396	Wall / Ceiling Liner	2400	20	SWL507	3.36	1.40
41591 3397		2700	20		3.78	1.40
41591 3400		3000	20		4.26	1.40
41591 3500		3600	20		5.04	1.40
41591 3300	Perimeter Track	3000	20	SWL60	3.60	1.20
41591 3706	Timber Connector	55	200	AWL06B		55.60/box
41591 3707	Timber Connector	155	100	AWL07B		42.52/box
41591 3712	Angle Fixing Bracket			AMF12B		78.50/box

CODE	DESCRIPTION	LENGTH (mm)	PIECES (per box)	REFERENCE	£ PRICE (per box)
41591 3701	Fixing Bracket	75mm leg	100	AWL03	25.54
41591 3702		125mm leg	100	AWL04	36.18
41591 3703	Wall / Ceiling Liner Connector		50	AWL05	23.94

SPEEDLINE RESILIENT BAR

CODE	DESCRIPTION	LENGTH (mm)	LENGTHS (per pack)	REFERENCE	£ PRICE (per length)	£ PRICE (per lm)
41591 3810	Resilient Bar	3000	10	RB565	4.29	1.43

SPEEDLINE FIRE BARRIER SYSTEM

CODE	DESCRIPTION	LENGTH (mm)	LENGTHS (per pack)	REFERENCE	£ PRICE (per length)	£ PRICE (per lm)
41525 0610	Pierced Angle 60 x 40 x 1.5mm	3000	10	FBAP	13.23	4.41
41525 0401	Flat Strip 40 x 1.5mm	3000	10	FBFP	6.66	2.22

SPEEDLINE ANGLES

CODE	LEG SIZE (mm)	DEGREE	LENGTH (mm)	LENGTHS (per pack)	REFERENCE	£ PRICE (per length)	£ PRICE (per lm)
41520 0053	19 x 19	90	3000	20	SL02	1.98	0.66
41520 0054			3600	20		2.38	0.66
41520 0103	22 x 22	90	3000	20	SL04	2.19	0.73
41520 0104			3600	20		2.63	0.73
41520 158X	25 x 25	90	3000	20	SL06	2.40	0.80
41520 1610			3600	20		2.88	0.80
41520 1851	25 x 25	135	3000	20	SL08	3.06	1.02
41520 1650			3600	20		3.68	1.02
41520 2212	50 x 25	90	3000	20	SL12	4.20	1.40
41520 2236			3600	20		5.04	1.40
41520 2306	50 x 50	90	3000	20	SL13	5.46	1.82
41520 2309			3600	20		6.55	1.82
41520 2400	50 x 50	90	3600	5	SL26	15.73	4.37

SPEEDLINE CHANNELS

CODE	SIZE (base x leg x gauge (mm))	LENGTH (mm)	LENGTHS (per pack)	REFERENCE	£ PRICE (per length)	£ PRICE (per lm)
41550 0013	38 x 12.7 x 0.8	3000	20	SU01	3.84	1.28
41550 0014		3600	20		4.61	1.28
41550 0078	38 x 19 x 1.5	3000	8	SU07	6.81	2.27
41550 007X		3600	8		8.17	2.27
41550 0080		6000	8		13.62	2.27
41550 0082	63 x 25 x 1.5	3600	160	SU08	13.97	3.88
41550 0083		4200	160		16.30	3.88
41550 0084		6000	120		23.28	3.88
41550 0092	75 x 38 x 1.5	3600	96	SU09	18.65	5.18
41550 0093		4000	96		20.72	5.18
41550 0094		4200	96		21.76	5.18
41550 1132	100 x 50 x 1.5	4800	50	SU12	36.53	7.61
41550 1162	100 x 50 x 2.0	4800	50	SU16	54.38	11.33

METAL COMPONENTS

SPEEDLINE ACCESSORIES

CODE	DESCRIPTION	LENGTH (mm)	LENGTHS (per pack)	REFERENCE	£ PRICE (per box)
41591 8016	Channel Connectors	38	400	AZ11	220.71
41591 8017		63	200	AZ12	168.92
41591 8018		75	80	AZ13	93.80

SPEEDLINE SEVERE DUTY SYSTEM*

CODE	DESCRIPTION	LENGTH (m)	REFERENCE	£ PRICE (per length)	£ PRICE (per lm)
41591 1160	75mm C Stud x 0.6mm Flange 48/50	2.4	AS75	9.46	3.94
41591 1162		2.7		10.64	3.94
41591 1165		3.9		11.82	3.94
41591 1167		3.6		14.18	3.94
41591 1169		4.2		16.55	3.94
41591 1171		4.5		17.73	3.94
41591 1173		6.0		23.64	3.94

* Please note this product is rolled to order

SPEEDLINE SEVERE DUTY SYSTEM DIMENSIONS

STUD SIZE BS5234	INSULATION MATERIAL	MAX HEIGHT (m)	NOMINAL WIDTH (mm)	FIRE RESISTANCE (mins)	SOUND INSULATION WITH INFIL RwdB	DOUBLE LAYER		REFERENCE
						10mm	12.5mm	
75	50mm Mineral Wool 50kg/m ³	5	120	90	62	12.5+10		1S31
Twin 75	50mm Mineral Wool 50kg/m ³	3.5	≥ 200	90	64	12.5+10		1S32
Twin 75 @ 400mm centre	50mm Mineral Wool 50kg/m ³	3.5	≥ 200	60	64	10+10		1S32/2

SPEEDLINE FIRE STRIP

CODE	DESCRIPTION	NO. (per box)	£ PRICE (per box)
Designed to give up to 60 minutes fire protection in deflection head details.			
39613 0010	25mm x 3mm x 3.6m roll	5	36.48



ALUMINIUM TRIMS

**Dry Lining Trims • Plasterboard Trims • Curved Trims
Skirting Trims • Suspended Ceiling Trims**

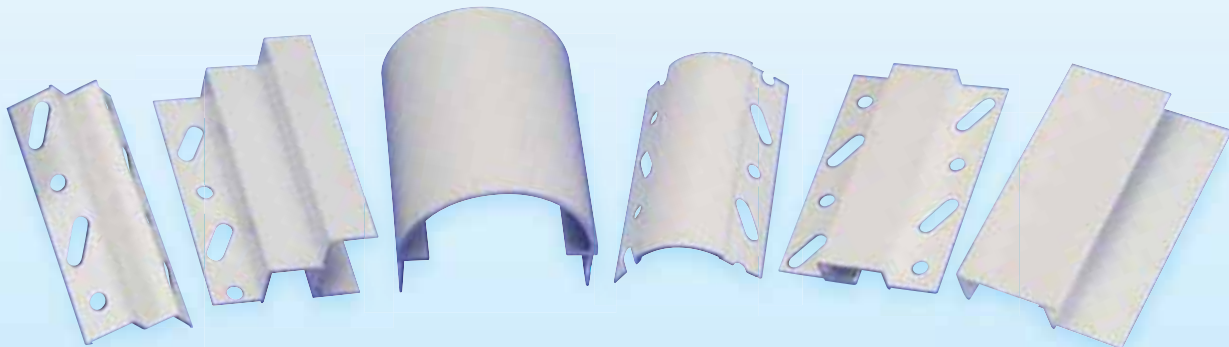

Your local Speedline stockist offers excellent customer service and fast delivery across the UK

See back cover for details

ALUMINIUM TRIMS & MESH

35

SPEEDLINE

SPEEDLINE ALUMINIUM TRIMS

CODE	DESCRIPTION	REFERENCE	£ PRICE (per lm)
Trims standard finish RAL9010, supplied in 3000mm straight lengths. For details of our full range of trims, please call your local stockist.			
73805 0050	Bullnose	B100	18.60
73805 0271	Corner	CE01	4.00
73805 0127	Corner Reveal	CE12	4.29
73805 0275	Rounded Corner	CE25	4.85
73805 0175	Round	CE75	13.32
73805 0131	Door Reveal	D25	4.48
73805 0124	Edge Stop	E12	2.77
73805 0123	Edge Reveal	R12	2.60
73805 0255	Edge Reveal	R25	3.13
73805 0552	Skirting	ST100	9.43
73805 0125	Reveal	W12	4.80
73805 0130	Reveal	W25	5.18
73805 0128	Single Step	Z12	3.94

See page 54 for guide to Aluminium Trims

SPEEDLINE SECURITY MESH

New Speedline Security Mesh provides a cost effective way of securing buildings or internal spaces by sandwiching a layer of mesh into the walls and ceilings during construction.

Available in a range of gauges, Speedline Security Mesh is suitable for internal walls, ceilings, partitions and external brickwork. A galvanised steel option is available where damp conditions are expected.

CODE	DESCRIPTION	MESH LW	MESH SW	STRAND WIDTH	STRAND THICKNESS	WEIGHT (kg per m ²)	SHEET SIZE	£ PRICE (per sheet)
Galvanised Steel Mesh suitable for roofs, metal stud walls, ceilings & timber stud walls								
98017 0412	Medium Duty	43.4	18	2.3	1.1	1.85	1250 x 2500	43.78
Mild Steel Mesh suitable for roofs, metal stud walls, ceilings & timber stud walls								
98017 0410	Heavy Duty	42.9	14.2	4.6	2.7	8.59	2440 x 1220	89.58
Galvanised Steel Mesh suitable for Masonry								
98017 0415	Heavy Duty Raised	50.8*	22.6*	3.1	3	6.52	2440 x 1220	66.95

*Mesh Pitch Size

SPEEDLINE METAL LATHING FOR EXTERNAL USE

CODE	DESCRIPTION	REFERENCE	MESH SIZE SWM (mm)	STRAND THICK (mm)	WEIGHT (kg per m ²)	SHEET SIZE LWxSW (mm)	£ PRICE (per sheet)
98017 1602	Riblath - Stainless Steel	267/600	10 mm Rib	0.3	1.16	2500 x 600	74.49

SPEEDLINE METAL LATHING FOR INTERNAL USE

CODE	DESCRIPTION	REFERENCE	GAUGE	MESH SIZE SWM (mm)	STRAND THICK (mm)	WEIGHT (kg per m ²)	SHEET SIZE LWxSW (mm)	£ PRICE (per sheet)
98017 1603	BB Metal Lathing	263	26	9	0.5	1.11	2500x700	15.36
98017 1599		264	24	9	0.725	1.61	2500x700	21.51
98017 1600		265	28	9	0.4	0.9	2500x700	10.06
98017 1605	Riblath	269/600	30	10mm Rib	0.3	1.15	2500x600	21.77
98017 1606		271/600	26	10mm Rib	0.5	1.93	2500x600	38.84

UPVC BEADS

SPEEDLINE ANGLE BEADS

CODE		DESCRIPTION	REFERENCE	LENGTHS (per carton)	WING SIZE (mm)	PLASTER DEPTH (mm)	LENGTH (mm)	£ PRICE (per carton)	£ PRICE (per lm)
CARTON	LENGTH								
	98017 1802	Standard	550	50	55	10 - 13	2400		1.36
	98017 1803		550				3000		1.36
	98017 1806	Maxicon	558	50	46	10 - 13	2400		1.07
98017 1824	98017 1809		558				2700	144.45	1.07
98017 1823	98017 1808		558				3000	160.50	1.07

SPEEDLINE PLASTER STOP BEADS

CODE		REFERENCE	LENGTHS (per carton)	WING SIZE (mm)	PLASTER DEPTH (mm)	LENGTH (mm)	£ PRICE (per carton)	£ PRICE (per lm)
CARTON	LENGTH							
98017 1816	98017 1717	562	50	60	10	2400	204.00	1.70
98017 1817	98017 171X	562	50	60		3000	255.00	1.70
98017 1833	98017 1718	563	50	60	13	2400	206.40	1.72
98017 1834	98017 1724	563	50	60		3000	258.00	1.72

SPEEDLINE THIN COAT ANGLE BEADS

CODE		REFERENCE	LENGTHS (per carton)	WING SIZE (mm)	PLASTER DEPTH (mm)	LENGTH (mm)	£ PRICE (per carton)	£ PRICE (per lm)
CARTON	LENGTH							
	98017 1800	553	50	23	3	2400		1.29
	98017 1793	553				2700		1.30
98017 1797	98017 1801	553				3000	195.00	1.30

SPEEDLINE THIN COAT STOP BEADS

CODE		REFERENCE	LENGTHS (per carton)	WING SIZE (mm)	PLASTER DEPTH (mm)	LENGTH (mm)	£ PRICE (per carton)	£ PRICE (per lm)
CARTON	LENGTH							
98017 2015	98017 1811	560	50	28	3	2400	230.61	1.93
98017 2016	98017 1812	560				3000	289.37	1.93

SPEEDLINE PLASTERBOARD EDGING BEADS

CODE		REFERENCE	LENGTHS (per carton)	WING SIZE (mm)	PLASTER DEPTH (mm)	LENGTH (mm)	£ PRICE (per carton)	£ PRICE (per lm)
CARTON	LENGTH							
98017 1722	98017 1830	567	50	24	10	3000		4.10
98017 1723	98017 1832	568		24	13	3000		4.10
98017 2023	98017 2029	576		24	15	3000	615.25	4.10

SPEEDLINE EXTERNAL RENDER STOP BEADS

CODE		DESCRIPTION	REFERENCE	LENGTHS (per carton)	WING SIZE (mm)	PLASTER DEPTH (mm)	LENGTH (mm)	£ PRICE (per carton)	£ PRICE (per lm)
CARTON	LENGTH								
98017 1736	98017 179X	Stainless Steel	547	25	53	16 - 20	3000	447.00	5.96
	98017 1738	S Steel - Std Wing	508	25	46	16 - 20	3000		4.40
98017 1846		Galvanised	570	50	53	16 - 20	3000	271.50	

SPEEDLINE UPVC BEADS FOR INTERNAL AND EXTERNAL USE

CODE	REFERENCE	LENGTHS (mm)	LENGTHS (per carton)	RENDER DEPTH MM (mm)	£ PRICE (per carton)	£ PRICE (per length)
Angle Bead						
98017 0090	PTC002	2500	25	3	70.70	2.83
98017 0112	PAB010	2500	25	10	141.67	5.67
98017 0113	PAB015	2500	25	13 - 16	147.67	5.90
98017 0114	PAB020	2500	25	20	164.05	6.56
Arch Bead						
98017 0102	PFB001	2500	25	3	92.26	3.69
Stop Bead						
98017 0122	PSB010	2500	25	10	137.57	5.50
98017 0123	PSB013	2500	25	13	137.57	5.51
98017 0124	PSB015	2500	25	15	137.57	5.60
98017 0125	PSB020	2500	25	20	160.49	6.42
Movement Bead						
98017 0140	PMB010	2500	25	10	341.50	13.66
98017 0141	PMB015	2500	25	13	350.75	14.03
98017 0142	PMB020	2500	25	15	359.75	14.39
Render Stop Bead						
98017 0131	PBC020	2500	25	20	231.75	9.27

See page 55 for guide to Beads



YOUR 1st CHOICE FOR BEADS & MESH

Speedline's range of top quality products provide the right solutions for your applications:

PLASTER BEADS FOR INTERNAL USE



SPEEDLINE ANGLE BEAD

Provides a true, straight corner which protects and reinforces plaster where it is most vulnerable. One size adjusts for thickness.

PLASTER BEADS FOR THIN-COAT PLASTER



SPEEDLINE THIN-COAT ANGLE BEAD

For 3mm plaster finishes on plasterboard or any smooth background.

BEADS FOR EDGING



SPEEDLINE PLASTERBOARD EDGING BEAD

A reversible, dual-purpose bead which reinforces plasterboard edges by enclosing them in a protective steel section.

PVC BEADS FOR INTERNAL AND EXTERNAL USE



SPEEDLINE PVC BEADS

All the benefits of traditional metal beads with the added advantage of a light flexible material.

SECURITY MESH FOR ROOFS, WALLS AND CEILINGS



SPEEDLINE SECURITY MESH

Provides a cost effective way of securing buildings or internal spaces.

LATHING



SPEEDLINE 95S LATHING & RIBLATH FOR PLASTER AND RENDER FINISHES

An excellent key for finishing materials on masonry, ceilings, suspended ceilings and timber frame buildings.



Available from your local stockists

See back cover for details

FIXINGS

SPEEDLINE BZP DRYWALL SCREWS (ZINC)

CODE	SIZE (mm)	DESCRIPTION	NO. (per box)	£ PRICE (per box)
A8250 0001	25	Drywall Screws - includes 1 PH2 Bit	1000	5.98
A8250 0002	32	Drywall Screws - includes 1 PH2 Bit	1000	7.37
A8250 0003	38	Drywall Screws - includes 1 PH2 Bit	1000	8.66
A8250 0004	42	Drywall Screws - includes 1 PH2 Bit	1000	11.30
A8250 0005	45	Drywall Screws - includes 1 PH2 Bit	1000	14.53
A8250 0006	50	Drywall Screws - includes 1 PH2 Bit	1000	14.73
A8250 0010	65	Drywall Screws - includes 1 PH2 Bit	500	11.30
A8250 0011	75	Drywall Screws - includes 1 PH2 Bit	500	11.67

SPEEDLINE BZP SELF DRILL DRYWALL SCREWS (ZINC)

CODE	SIZE (mm)	DESCRIPTION	NO. (per box)	£ PRICE (per box)
A8255 0001	25	Self Drill Drywall - includes 1 PH2 Bit	1000	12.05
A8255 0002	32	Self Drill Drywall - includes 1 PH2 Bit	1000	15.45
A8255 0003	38	Self Drill Drywall - includes 1 PH2 Bit	1000	18.64
A8255 0004	42	Self Drill Drywall - includes 1 PH2 Bit	1000	19.96
A8255 0006	50	Self Drill Drywall - includes 1 PH2 Bit	1000	23.72
A8255 0007	65	Self Drill Drywall - includes 1 PH2 Bit	500	20.71
A8255 0008	75	Self Drill Drywall - includes 1 PH2 Bit	500	23.63

SPEEDLINE COARSE THREAD DRYWALL SCREWS INC BITS

CODE	SIZE (mm)	DESCRIPTION	NO. (per box)	£ PRICE (per box)
Specifically designed for installation of boards directly onto timber framework. The coarse thread provides excellent drive and grip for quick and easy installation.				
A8235 0001	25	Coarse Thread Drywall Screws + Bit	1000	7.90
A8235 0002	32	Coarse Thread Drywall Screws + Bit	1000	10.54
A8235 0003	38	Coarse Thread Drywall Screws + Bit	1000	11.29
A8235 0004	42	Coarse Thread Drywall Screws + Bit	1000	14.68
A8235 0005	50	Coarse Thread Drywall Screws + Bit	1000	15.06
A8235 0006	65	Coarse Thread Drywall Screws + Bit	500	15.44
A8235 0007	75	Coarse Thread Drywall Screws + Bit	500	22.21

SPEEDLINE COLLATED DRYWALL SCREWS

CODE	SIZE (mm)	DESCRIPTION	NO. (per box)	£ PRICE (per box)
Suitable for use with a wide range of auto feed screw drivers. The collated drywalls allow quick installation of screws into plasterboard.				
A8225 0001	25	Black Phosphated Collated Drywall Screws (in strips of 50)	1000	17.56
A8225 0003	35		1000	20.77
A8225 0004	38		1000	20.77
A8225 0007	50		1000	22.84
A8233 0001	25	BZP Self Drill Collated Drywall Screws (in strips of 50)	1000	21.34
A8233 0002	35		1000	24.35
A8230 0002	30	BZP Countersink Collated Drywall Screws (in strips of 50)	1000	24.71

SPEEDLINE PAN/WAFER HEAD SELF DRILL

CODE	SIZE (mm)	DESCRIPTION	NO. (per box)	£ PRICE (per box)
Self Drilling Wafer and Pan Head Screws available zinc only with Phillips recess. Suitable for maximum 1.2mm metal stud.				
A8275 0001	13	Pan Head Self Drill - includes 1 PH2 Bit	1000	13.75
A8275 0004	25	Pan Head Self Drill - includes 1 PH2 Bit	1000	14.35
A8275 0003	13	Wafer Head Self Drill - includes 1 PH2 Bit	1000	14.88
A8275 0002	13	Wafer Head Non Self Drill	1000	18.26

SPEEDLINE PLUGS

CODE	SIZE (mm)	DESCRIPTION	NO. (per box)	£ PRICE (per box)
General purpose fixing into brick and concrete.				
A8580 0004		Plastic Plugs Yellow	100	0.81
A8580 0005		Plastic Plugs Red	100	0.91
A8580 0006		Plastic Plugs Brown	100	1.08
A8570 0002		Nylon Plugs 6mm	100	6.38

SPEEDLINE METAL NAIL- INS

CODE	SIZE (mm)	DESCRIPTION	NO. (per box)	£ PRICE (per box)
Suitable applications into concrete and full bricks for fixing brackets, straps, general sheet items.				
A8555 0003	6 x 30	Metal Nail Ins	200	26.19
A8555 0004	6 x 40	Metal Nail Ins	100	17.03
A8555 0002	6 x 65	Metal Nail Ins	100	29.30

SPEEDLINE HAMMERFIX NYLON

CODE	SIZE (mm)	DESCRIPTION	NO. (per box)	£ PRICE (per box)
Suitable applications include concrete, brick and hollow concrete block.				
A8530 0015	5 x 30	Hammerfix Nylon	300	19.49
A8530 0016	5 x 40	Hammerfix Nylon	200	16.36
A8530 0017	6 x 40	Hammerfix Nylon	200	13.11
A8530 0047	6 x 50	Hammerfix Nylon	100	14.24
A8530 0018	6 x 60	Hammerfix Nylon	100	10.47
A8530 0019	6 x 80	Hammerfix Nylon	100	11.62
A8530 0022	8 x 60	Hammerfix Nylon	150	27.83
A8530 0023	8 x 80	Hammerfix Nylon	150	30.45
A8530 0046	8 x 100	Hammerfix Nylon	100	22.59
A8530 0021	8 x 120	Hammerfix Nylon	100	26.86

See page 53 for guide to Fixings

JOINTING PRODUCTS

SPEEDLINE READYMIX

CODE	DESCRIPTION	TUBS (per pallet)	PALLET WEIGHT	COVERAGE	TUB SIZE	£ PRICE (per tub)
73864 0020	Lightweight All Purpose Joint Compound	45	900kg	30-36 litres/100m ²	17L	32.15

SPEEDLINE TAPES

CODE	DESCRIPTION	ROLL SIZE	NO. (per box)	£ PRICE (each)
73895 5000	Self Adhesive Drywall Scrim	48mm x 90m	24	4.82
73895 0200	Paper Joint Tape	50mm x 150m	10	4.82
73895 0160	Corner Tape (with bonded steel strips)	50mm x 30m	10	20.25
73895 0150	Self Adhesive Fibre Tape	50mm x 90m		4.82
73886 9000	Tape Dispenser			18.95

SPEEDLINE SANDING PAPERS

CODE	DESCRIPTION	NO. (per pack)	£ PRICE (per pack)
73895 1000	A4 Sanding Papers 100 Grit	25	9.07
73895 1001	A4 Sanding Papers 120 Grit	25	9.07
73895 1002	A4 Sanding Papers 150 Grit	25	9.07



TAPES & SANDING PAPERS



Your local Speedline stockist offers excellent customer service and fast delivery across the UK

See back cover for details

SPEEDLINE SEALANTS & ADHESIVES			
CODE	DESCRIPTION	SIZE	£ PRICE (per item)
45501 0010	Acoustic Sealant	310ml	6.13
45501 0020	Acoustic Sealant	900ml	11.97
45501 0030	4 Hour fire rated acoustic mastic	310ml	7.04
45501 0040	4 Hour fire rated acoustic mastic	900ml	12.36
45501 0050	Wall & Panel Adhesive	310ml	7.26
45501 0060	PVA Tub	5kg	12.95
45501 0080	Expanding Filler	750ml	16.93
45501 0200	Sealant Gun	380ml	7.06
45501 0201	Sealant Gun	900ml	25.57
46541 0100	Soundseal	828ml	15.90
46541 9000	Soundseal Applicator		26.50
46537 0320	Intumescent Mastic	310ml Cartridge (25)	4.34
45501 0005	Intumescent Acrylic Foil Pack (Sausage)	600ml	6.40
45501 0006	Intumescent Acrylic Foil Pack (Sausage)	600ml 12 boxes	76.80
45501 0007	Foil Pack Application Gun		20.16



SEALANTS & ADHESIVES



An extensive range of sealants & adhesives are available from your local Speedline stockist including Acoustic Sealant, PVA Bond, Intumescent Acrylic & applicator guns and fire rated foams for sealing partitions, door casings and firewalls

See back cover for details

ACCESSORIES

SPEEDLINE ACOUSTIC FIRECAPS

CODE	DESCRIPTION	REFERENCE	£ PRICE (each)
39609 0050	For cut out 50-75mm	AFF 109/150	14.99
39609 0075	For cut out 75-100mm	AFF 109/200	15.99
39609 0100	For cut out 100-140mm	AFF 109/250	20.35
39609 0140	For cut out 140-250mm	AFF 109/300	32.30
39609 0144	For cut out 140 - 270mm	AFF 109/350	34.99

SPEEDLINE PUTTY PADS

CODE	DESCRIPTION	THICKNESS (mm)	ROLL SIZE	APPROX COVERAGE (per roll)	£ PRICE (per roll)
45501 1000	Putty Pads	3.2	178mm x 3.6m	27 single boxes or 20 double	322.00

SPEEDLINE CHIPBOARD

CODE	DESCRIPTION	SIZE (mm)	BOARDS (per pallet)	£ PRICE (per board)
97870 1180	Moisture resistant P5, V313, T & G	18 x 600 x 2400	78	9.08
97870 1220	Moisture resistant P5, V313, T & G	22 x 600 x 2400	64	11.19
97870 3180	Speedline Safedek with peel off membrane	18 x 600 x 2400	78	20.46
97870 3220	Speedline Safedek with peel off membrane	22 x 600 x 2400	64	23.87

SPEEDLINE PROTECTION BOARD

Speedline Protection Board is a versatile corrugated polypropylene board providing excellent multi-surface impact protection during site works. It can be used to protect floors, walls, partitions, doors, furniture, formwork etc.

CODE	DESCRIPTION		DIMENSIONS (mm)	WEIGHT (per m ²)	£ PRICE (per m ²)	£ PRICE (per sheet)
	COLOUR	FLAME RETARDENT				
38058 0020	White*	Yes	2x1200x2400	250g	1.41	4.05
38058 0022	White	Yes	2x1200x2400	250g	1.41	4.05
38058 0025	Black	No	2x1200x2400	250g	0.96	2.76
38058 0027	Black*	No	2x1200x2400	250g	1.14	3.29
38058 0028	Transparent	No	2x1200x2400	250g	1.02	2.94
38058 0029	Transparent	No	2x1200x2400	250g	1.20	3.47
38058 0040	Black	No	4x1200x2400	700g	2.69	7.74
38058 0041	Black*	No	4x1200x2400	700g	2.87	8.27
38058 0045	Transparent	No	4x1200x2400	700g	2.88	8.29
38058 0046	Transparent*	No	4x1200x2400	700g	3.06	8.82

Non-standard sizes and colours available

* Indicates that the product has a Speedline logo printed on it.

SPEEDLINE THERMAL LAMINATE PLASTERBOARD

A combination of a 12.5mm plasterboard (tapered edge), factory bonded to a high performance polyisocyanurate foam (PIR) insulant. Within the design of the board, a vapour control layer is an optional feature to reduce the risk of condensation.

Other types of insulant such as expanded polystyrene (EPS), extruded polystyrene (XPS), mineral wool and phenolic are also available as a backing to the plasterboard.

CODE	THICKNESS (mm)	WIDTH (mm)	LENGTH (mm)	£ PRICE (per m ²)	£ PRICE (per board)
19277 0250	25/12.5	1200	2400	7.74	22.29
19277 0300	30/12.5	1200	2400	8.28	23.85
19277 0350	35/12.5	1200	2400	8.84	25.46
19277 0500	50/12.5	1200	2400	10.90	31.39
19277 0600	60/12.5	1200	2400	12.16	35.02
19277 0700	70/12.5	1200	2400	14.24	41.01

Manufactured in any quantity

When applied to the ceiling, must be directly fixed to the rafters after the removal of any existing plaster or plasterboards. The board is always screw fixed to the rafter.

SPEEDLINE BREATHABLE MEMBRANE

A high performance vapour permeable underlay for use in non-vented and vented cold or warm pitched roofs.

CODE	ROLL (length x width)	ROLL WEIGHT	ROLL WEIGHT (per m ²)	£ PRICE (per roll)
73868 1001	50 x 1m	6.1kg	120g/m ²	130.00
73868 1501	50 x 1.5m	9.2kg	120g/m ²	195.00

SPEEDLINE ACCESS PANELS

CODE	DESCRIPTION	SIZE (mm)	£ PRICE (each)
Access Panels are available for both walls and ceilings with metal or plasterboard doors, beaded or picture frame, non-fire rated or 4 hour fire rated. Panels are also available with up to a 46dB rating			
Standard Panels - Ceiling Access			
73811 0664	Metal Door with Picture Frame (EX/MT/PF)	300 x 300	97.33
73811 0728		450 x 450	111.04
73811 0899		600 x 600	123.59
73811 0702	Plasterboard Door with Beaded Frame (EX/PB/SB)	300 x 300	113.30
73811 0722		450 x 450	131.56
73811 0706		600 x 600	142.75
Standard Panels - Wall Access			
73811 0920	Metal Door with Picture Frame (EX/WD/PF)	300 x 300	97.45
73811 0596		450 x 450	115.68
73811 0718		600 x 600	124.63
Standard Panels - Ceiling or Wall Access with budget lock			
73811 0070	Fire Rated with Picture or Beaded Frame (EX/XL/FD)	300 x 300	145.64
73811 0071		450 x 450	166.21
73811 0072		600 x 600	180.40
Loft Panels			
73811 9073	Fire Rated (EX/LOFT/PF/FD) with Picture Frame	530 x 740	102.66
73811 9075		555 x 655	99.18
73811 4250	Fire Rated with Picture Frame & 3 way lock (LH/PF/FD/3W)	740 x 530	84.70
73811 4252		555 x 655	84.70

OTHER SPEEDLINE PRODUCTS ARE AVAILABLE



ACCESS ALL AREAS...

... WITH SPEEDLINE ACCESS PANELS

Fully tested & certified • Ex stock

Comprehensive range

Fire rated • Insulated • Acoustic • Airtight • Loft spaces

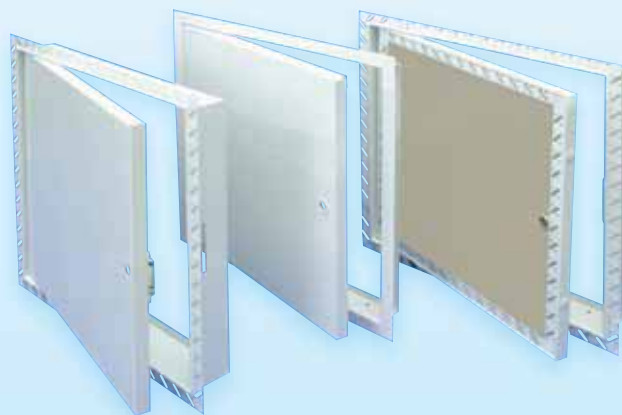

For easy access to maintain services in any void or cavity

See back cover for details of your local stockist

STEEL FRAME SYSTEMS



METSEC STEEL FRAMING SYSTEMS

CODE	REFERENCE	SIZE (mm)	LENGTH	£ PRICE (per lm)
Stud Joist				
41840 0068	70M15	70 x 35 x 1.5	3.6m	7.21
41840 0070	70M15	70 x 35 x 1.5	4.2m	7.21
	100M12	100 x 54 x 1.2	to order	8.34
	100M15	100 x 55 x 1.5	to order	11.57
	100M20	100 x 56 x 2.0	to order	15.51
	150M12	150 x 57 x 1.2	to order	10.43
	150M15	150 x 60 x 1.5	to order	14.20
	150M20	150 x 60 x 2.0	to order	19.02
	200M12	200 x 57 x 1.2	to order	12.37
	200M15	200 x 69 x 1.5	to order	16.58
	200M20	200 x 69 x 2.0	to order	22.15
	250M16	250 x 68 x 1.6	to order	17.89
	250M20	250 x 68 x 2.0	to order	23.81
	300M20	300 x 60 x 2.0	to order	27.63
	300M29	300 x 62 x 2.9	to order	40.21
Channel Runner				
41841 0074	74M12	74 x 40 x 1.2	3.0m	5.93
41841 0104	104M12	104 x 62 x 1.2	3.0m	7.59
41841 0105	104M12	104 x 62 x 1.2	4.0m	7.59
41841 0106	104M15	104 x 63 x 1.5	3.0m	10.60
41841 0107	104M15	104 x 63 x 1.5	4.0m	10.60
41841 0154	154M12	154 x 63 x 1.2	3.0m	9.62
41841 0155	154M12	154 x 63 x 1.2	4.0m	9.62
41841 0204	204M12	204 x 63 x 1.2	3.0m	11.55
41841 0205	204M12	204 x 63 x 1.2	4.0m	11.55
41841 0254	254M12	254 x 38 x 1.2	3.0m	12.36
41841 0255	254M12	254 x 38 x 1.2	4.0m	12.36
	304M16	304 x 50 x 1.6	3.0m	20.83
	304M16	304 x 50 x 1.6	4.0m	20.83
Deep Runner				
41841 1174	74M20	74 x 65 x 2.0	3.0m	13.01
41841 1104	104M20	104 x 63 x 2.0	3.0m	15.65
41841 1105	104M20	104 x 63 x 2.0	4.0m	15.65
41841 1154	154M20	154 x 66 x 2.0	3.0m	18.95
41841 1155	154M20	154 x 66 x 2.0	4.0m	18.95
41841 1204	204M20	204 x 75 x 2.0	3.0m	20.78
41841 1205	204M20	204 x 75 x 2.0	4.0m	20.78
41841 1254	254M20	254 x 75 x 2.0	3.0m	26.22
41841 1255	254M20	254 x 75 x 2.0	4.0m	26.22
41841 1304	304M20	304 x 68 x 2.0	3.0m	28.02
41841 1305	304M20	304 x 68 x 2.0	4.0m	28.02
41841 1306	306M29	306 x 68 x 2.9	3.0m	39.66
41841 1307	306M29	306 x 68 x 2.9	4.0m	39.66

METSEC STEEL FRAMING SYSTEMS CONTINUED

CODE	REFERENCE	SIZE (mm)	LENGTH	£ PRICE (per lm)
Bracing				
41840 1340	38VB09	38 x 0.9	4.0m	2.35
41840 1004	100VB12	100 x 1.2	4.0m	4.42
Angle Section				
		45 x 45 x 2.0	to order	3.74
		100 x 50 x 2.0	to order	6.36
		100 x 100 x 2.0	to order	8.64

Due to the range of sizes offered, Metsec is not a standard stock item. Please allow up to 15 working days for delivery. The above prices exclude delivery, manufacturer carriage charges will apply.

DEFLECTION HEAD BRACKETS

CODE	DESCRIPTION	£ PRICE (per box)	£ PRICE (each)
For use with Metsec SFS systems to avoid the need for another channel or bracing strap to be used between studs, helping to speed up installation.			
41845 0100	100L Speedline deflection head bracket	280.86	2.81
41845 0150	150L Speedline deflection head bracket	301.66	3.02
41845 0200	200L Speedline deflection head bracket	332.87	3.33

FERMACELL DRY LINING BOARD

CODE	THICKNESS (mm)	WIDTH (mm)	LENGTH (mm)	BOARDS (per pallet)	WEIGHT PER PALLET (tonnes)	£ PRICE (per m ²)	£ PRICE (per board)
A gypsum fibre board which can also provide fire performance, acoustic performance, impact resistance and hanging strength.							
73807 0105	10	1200	2400	60	2.104	7.44	21.43
73807 0125	12.5	1200	2400	48	2.038	8.97	25.83

FERMACELL BOARD ACCESSORIES

CODE	DESCRIPTION	SIZE	USAGE	£ PRICE (per item)
Joint Stik - For butt jointing Fermacell wall and ceiling boards.				
73807 9455	Fermacell Joint Stik	310ml Tube	20 Lm per Cartridge	9.18
73807 9535	Joint Stik Hand Applicator	1.25 kg	-	47.84
Joint Filler - For filling 5-7mm gap between boards, finishing glue joints and stopping screwheads, etc.				
73807 9805	Fermacell Joint Filler	5kg Bag	7-8 Lm per kg	9.23
Fine Surface Treatment - For smoothing board surface prior to semi-gloss paint application.				
73807 9812	Fermacell Fine Surface Treatment	2.5L Tub	6m ² per L	10.84
73807 9815		10L Tub	6m ² per L	34.20

CODE	DESCRIPTION	SIZE	USAGE	QUANTITY (per box)	£ PRICE (per box)
Screws - For fixing Fermacell to steel subframes of greater than 0.7mm gauge.					
73807 9300	Fermacell Cross-Slot Screws	3.9mm x 30mm	10-13m ² for each side of partition	1000	31.82
73807 8000		3.9mm x 45mm	10-13m ² for each side of partition	1000	46.82
73807 9285	Fermacell Drill Head Screws	3.5mm x 25mm	10-13m ² for each side of partition	1000	57.98

FERMACELL TAPES

CODE	DESCRIPTION	WIDTH (mm)	ROLL LENGTH (lm)	£ PRICE (per roll)
73807 9826	Mesh Jointing Tape	60	45	13.28
73807 9827	Paper Jointing Tape	53	75	7.74
73807 9830	Joint Repair Tape	70	50	16.91

OTHER FERMACELL BOARDS & ACCESSORIES ARE AVAILABLE



Orange is
the new
green

FERMACELL'S famous orange logo tells you you've got a highly sustainable building board – made from 100% recycled materials, with an onsite recycling service to collect site waste and reprocess offcuts. FERMACELL also helps you create healthy, allergy-free living and working conditions. It has been shown not to promote mould growth in a Fraunhofer Institute for Building Physics study, and awarded the coveted Rosenheim Institute of Construction Biology and Ecology Certificate. With so much pressure to be green these days, it's time to think orange.

www.fermacelldrylining.co.uk

fermacell

TILE BACKER BOARDS

TILE BACKER BOARDS

Other sizes and products are available, please contact your local branch for details.

CODE	MANUFACTURER	PRODUCT NAME	DIMENSIONS (mm)	UNIT	£ PRICE (per unit)
36042 6009	Eternit	Hydropanel	9 x 1200 x 2500	m ²	19.99
39626 0010	Euroform	Versaliner JPM	10 x 1200 x 2400	Sheet	21.42
39626 1255			12.5 x 1200 x 2400	Sheet	28.59
73852 0061	James Hardie	Hardibacker	250 Grid 1500 x 900 x 6	m ²	10.35
73852 0121			500 G2 1200 x 800 x 12	m ²	11.28
73852 9013		Fibatape Jointing Tape	50 x 15m	Roll	3.87
73745 1121	Knauf	Aquapanel Exterior Cement Board	12.5 x 900 x 2400	m ²	25.59
73745 1123		Aquapanel Interior Cement Board	12.5 x 900 x 1200	m ²	25.59
73745 1127			12.5 x 900 x 2400	m ²	25.59
73745 1102		Aquapanel Thermal Board	10 x 600 x 1200	m ²	39.62
73938 0850	Lafarge	GTEC Aqua Board	12.5 x 1200 x 850*	m ²	38.92
73938 2400			12.5 x 1200 x 2400*	m ²	38.92
73938 2700			1200 x 2700	m ²	38.92
73938 5150			15 x 1200 x 2400	m ²	48.04
73854 0060	Marmox	Tile Backer board	6 x 600 x 1250	Board	16.74
73854 0100			10 x 600 x 1250		17.56
73854 0127			12.5 x 600 x 2500		37.59
73854 0500			50 x 600 x 1250		26.58
73854 9000		Reinforcing Tape	48 x 90m	Roll	9.98
73854 9010		Waterproof Tape	10m	Roll	58.49
73816 0125	Wedi	Tile Backer Board	12.5 x 2500 x 600	Board	34.78
73816 0205			20 x 2500 x 600		43.26
73816 9010		WT10 Tape	10	Roll	108.70
73816 9026		TT25 Joint Reinforcement	25	Roll	27.66

*Half Pallets available upon request

WEBER.PRAL M - MONOCOUCHE RENDER

CODE	COLOUR + REF No.	BAGS (per pallet)	WEIGHT (per bag kg)	£ PRICE (per bag)
12 Standard Colours				
73896 0251	000 White	40	25	21.13
73896 0245	016 Ivory	40	25	21.13
73896 0249	041 Cream	40	25	21.13
73896 0261	019 Sand	40	25	21.13
73896 0254	080 Brick Red	40	25	21.13
73896 0259	012 Earth	40	25	21.13
73896 0256	276 Stone Grey	40	25	21.13
73896 0262	210 Granite Grey	40	25	21.13
73896 0263	038 Sage Green	40	25	21.13
73896 0264	200 Azure Blue	40	25	21.13
73896 0266	232 Buff	40	25	21.13
73896 0267	101 Parchment	40	25	21.13

24 Special colours available in 25kg bags: Made to order only.

WEBER ACCESSORIES

CODE	PRODUCT	£ PRICE (per item)
73896 2030	Ashlar Tool	155.29
73896 2031	Ashlar Blade	34.12
73896 2552	Scraper Long Teeth (10mm)	11.92
73896 2553	Scraper Short Teeth (6mm)	11.92
73896 2038	10mm Ashlar Cutter	56.36
73896 2035	20mm Ashlar Cutter	56.36
73896 1993	Straight Edge 1.2m	24.54
73896 1990	Serrated Straight Edge 1.2m	24.54
73896 2554	I Section Scraping Edge 1.2m	11.92
73896 0502	Standard Mesh Cloth 1m x 50m roll	90.97

ADDITIVES, ADMIXTURES AND MINERAL PAINT

CODE	PRODUCT	COLOUR	SIZE	£ PRICE (per item)
73896 2630	Ibocar Accelerator		10 x 2kg sachets	150.77
73896 2631	Ibovit 2 Accelerator		20L	121.13
73896 4048	Adflex		1L	9.45
73896 4050			2.5L	20.05
73896 4052			5L	37.32
73896 0391	Weber Sil P	White	10L	90.54
73896 0398	Weber Sil P	Cream	10L	90.54
73896 0392	Weber Sil P	Ivory	10L	90.54
73896 0450	Triple Strength Medusa - 20 sachets		330g (each)	147.78
73896 0451	Triple Strength Medusa - 1 bag		20kg	143.17
73896 2625	Weber CL150 Algicide	Clear	5L	21.96
73896 2626	Weber CL150 Algicide	Clear	25L	44.63
73896 2616	Weber CL150 Algicide	Tinted	25L	54.10

NB: Further increases may apply during 2010.
Contact your local branch for details.

EXTERNAL RENDERS

WEBER DECORATIVE FINISHES - CULLAMIX TYROLEAN

CODE	COLOUR	BAGS/BUCKETS (per pallet)	WEIGHT (per bag/bucket kg)	£ PRICE (per bag/bucket)
73896 0180	White	40	25	22.83
73896 0181	Ivory	40	25	20.56
73896 0182	Grey	40	25	20.56
73896 0183	Butter	40	25	20.56
73896 0184	Silver	40	25	20.56
73896 0185	Limestone	40	25	20.56

WEBER DECORATIVE FINISHES - FLEXIREND HIGHBUILD

CODE	COLOUR	BAGS/BUCKETS (per pallet)	WEIGHT (per bag/bucket kg)	£ PRICE (per bag/bucket)
73896 0200	White	40	15	44.84
73896 0201	Ivory	40	15	44.84
73896 0202	Grey	40	15	44.84
73896 0203	Butter	40	15	44.84
73896 0204	Silver	40	15	44.84
73896 0205	Limestone	40	15	44.84
73896 0206	Bathstone	40	15	44.84
73896 0207	Mushroom	40	15	44.84
73896 0208	Oyster	40	15	44.84
73896 0209	Terracotta	40	15	44.84

WEBER - OTHER FINISHES & ACCESSORIES

CODE	PRODUCT	COLOUR	BAGS/BUCKETS (per pallet)	WEIGHT (per bag/bucket kg)	£ PRICE (per bag/bucket)
73896 0190	Alpine Finish	White	64	25	50.63

CODE	PRODUCT	£ PRICE (per item)
73896 2040	Tyrolean Machine	174.50

WEBER BASE COAT RENDERS AND STIPPLE COATS

CODE	PRODUCT	BAGS (per pallet)	WEIGHT (per bag kg)	£ PRICE (per bag)
73896 0140	weber.rend OCR	40	25	6.69
73896 0130	weber.rend Aid	40	25	17.48
73896 0142	weber.rend Stipple	64	25	27.01
73896 2097	weber.rend PUC	64	25	30.26
73896 0538	weber.rend LAC	40	20	27.76

WEBER APPLICATION INFORMATION

PRODUCT	COVERAGE (approx)
Adflex	1.6 litres per 25kg render
Alpine	1.52kg per m ² for each mm of thickness
CL150 Algicide	0.1 litre per m ²
Cullamix Tyrolean	1 bag per 5m ² (4-6mm thick)
Flexirend Highbuild	1.7kg per m ² for each mm of thickness
Ibocar Accelerator	1 sachet (added to mix) covers 15lm of traditional edges
Ibovit 2 Accelorator	0.1 litres per 25kg bag of Monocouche
Triple Strength Medusa	330g sachet per 50kg cement
Weber Sil P	0.25 – 0.5 litre per m ²
Weber.Pral M	1 bag per m ² (15mm thick)
Weber.Rend Aid (trowel applied)	1.4kg per m ² for each mm of thickness or 7.5m ² per 25kg bag at 2-3mm thickness
Weber.Rend LAC	3kg per m ² as fixing insulant or 6.5kg per m ² at 6mm thickness for meshcloth coat
Weber.Rend OCR	1 bag per 0.9m ² (16mm thick)
Weber.Rend PUC	18kg per m ² at 10mm thickness
Weber.Rend Stipple	5kg per m ² at 2-3mm thickness

NB: Further increases may apply during 2010.
Contact your local branch for details.



Monocouche Render

- High performance through coloured external renders
- Available in 25kg bags for pump or hand application - just add water
- Extensive colour range available
- Ability to create three-dimensional architectural features, surface texturing and ashlars
- For application to most suitably prepared brick and block work



EXTERNAL RENDERS K-REND Kilwaughter Chemicals Company Limited

K-REND COLOURED EXTERNAL RENDER FINISHES

SMOOTH TEXTURED FINISHES	APPLICATION METHOD	BAGS (per pallet)	WEIGHT (per bag kg)	£ PRICE (per bag)
Silicone FT (Fine Texture)	Trowel applied	70	25	20.51
Silicone WP (Pitted Finish)	Trowel applied	70	25	20.51
Com-Rend S	Trowel & any render spray machine	70	25	22.29
Silicone E-Grade Spray Rend	Any render spray machine	70	25	22.29

ROUGHCAST/DRY DASH FINISHES	APPLICATION METHOD	BAGS (per pallet)	WEIGHT (per bag kg)	£ PRICE (per bag)
Silicone Dash Receiver	Trowel applied	70	25	20.51
Overcoating Silicone Dash Receiver	Trowel applied	70	20	20.51
Silicone Spray Dash Receiver	Diesel spray machine	70	25	21.23
Silicone Roughcast	Trowel applied	70	25	20.51

The above renders are available in all 20 standard colours:

White, Sterling White, Polar White, Ivory, Buttermilk, Arran, Cream, Oatmeal, York, Fintry Stone, Cinnamon, Sandstone, Champagne, Salmon Pink, Terracotta, Grey, Pewter Grey, Green, Powder Grey, Stone.

K-REND BASE COATS

PRODUCT	APPLICATION METHOD	BAGS (per pallet)	WEIGHT (per bag kg)	£ PRICE (per bag)
UF Base	Trowel & any render spray machine	70	25	9.53
UF Fibre Base	Trowel & any render spray machine	70	25	10.15
HP12 Base	Trowel & any render spray machine	70	25	10.55
HPX Base	Trowel & any render spray machine	70	25	20.50

K-REND BLOCK MORTAR / PARGETING RENDER

PRODUCT	APPLICATION METHOD	BAGS (per pallet)	WEIGHT (per bag kg)	£ PRICE (per bag)
K-MIX Block Mortar	Trowel applied	70	25	6.97
K-MIX Pargeting Render	Any render spray machine	70	25	6.97

K-REND ACCESSORIES

PRODUCT	SIZE	£ PRICE (per item)
Reinforcing Mesh	1 x 50m roll	164.08
Scraping Tool	275 x 105mm	22.54
Liquid Polymer R7 Acrylic	25 Litre container	179.37
Ashlar Cutter		92.24
Spatula	22"	34.12
Darby	4ft	26.54
I Beam Scraping Tool	4ft	30.33
H Section Feather Edge	4ft	34.12
H Section Serrated Edge	4ft	37.91

K-REND COVERAGE GUIDE

PRODUCT	COVERAGE	
	MACHINE APPLIED	HAND APPLIED
Com-Rend S	26-32kg per m ² at 16-20mm thickness	32-36kg per m ² at 16-18mm thickness
Dash Receiver	10-15kg per m ² at 6-10mm thickness	N/A
HP12 Base	8-11kg per m ² at 4-6mm thickness	N/A
HPX Base	6-9kg per m ² at 4-6mm thickness	N/A
K-MIX Block Mortar	10-18kg per m ²	N/A
K-MIX Pargeting Render	10-15kg per m ² at 6-8mm thickness for a mortar layer and 5-10kg at 3-5mm thickness as a face layer	N/A
Overcoating Silicone Dash Receiver	8-10kg per m ² at 8-10mm thickness	N/A
Silicone E-Grade Spray	26-32kg per m ² at 16-20mm thickness	N/A
Silicone FT / WP	32-36kg per m ² at 16-18mm thickness	20-24kg per m ² at 10-12mm thickness
Silicone Roughcast	10-15kg per m ² at 6-10mm thickness	N/A
Silicone Spray Dash Receiver	10-15kg per m ² at 6-10mm thickness	N/A
UF Base	14-18kg per m ² at 8-10mm thickness	N/A
UF Fibre Base	14-18kg per m ² at 8-10mm thickness	N/A

STAINLESS STEEL FIXING CHANNEL & ACCESSORIES

Used for tying brickwork to steel studding.

CODE	MANUFACTURER	PRODUCT NAME	DIMENSIONS	UNIT	£ PRICE	
A8690 0050	SIG SCP	25/14 Fixing Channel	2700	1m	7.56	
A8690 0055		Wall Ties - 100mm Projection		per 100	78.12	
A8690 0060		Wall Ties - 125mm Projection		per 100	88.20	
A8690 0063		Wall Ties - 150mm Projection		per 100	99.96	
A8690 0066		Wall Ties - 175mm Projection		per 100	112.98	
A8690 0069		Wall Ties - 200mm Projection		per 100	151.20	
A8690 0072		Fixing Screws - High Thread TEK C/W G12 washer bright zinc plated no.2 drill point	5.5 x 65		each	24.98
A8690 0075		Drive Socket - TEK Screw Adaptor Drive Unit	5/16 magnetic bit		each	16.80

SCREEDING ACCESSORIES

Other sizes and products are available, please contact your local branch for details.

CODE	MANUFACTURER	PRODUCT NAME	DIMENSIONS	UNIT	£ PRICE (per unit)
29689 0017	Collecta	Yelofon HD10 + Surebond Kit 50M	1.5m x 33.33m	Pack	419.24
97999 0040	CMS	Regupol 7210C	5mm x 1.15m x 2.3m	m ²	6.93
21659 1003	DOW	Floormate 200-X	100mm x 600mm x 2500mm	m ²	35.80
46242 0050	Dragon Alfa	Portland Cement	25kg bag, 64 bags per pallet	Bag	7.06
98040 2070	Glidevale	Prot TF200 Thermo Insulation Breather Membrane	100m x 2.7m	Roll	995.00
97914 7000	Karma	Underscreed	5mm x 1150mm x 2300mm	m ²	9.00
97917 0105		Perimeter Strip - white	5mm x 100mm x 25m	Each	25.00
97914 7015		Internal Corner Piece		Each	12.50
97914 7020		Acoustic Tape	100mm x 50m	Roll	16.25
73765 0118	Knauf	Brio Dry Screed Boards	18mm x 600mm x 1200mm	Board	15.21
73765 0230			23mm x 600mm x 1200mm	Board	18.37
73765 1118		Brio WF Dry Screed Boards	28mm x 600mm x 1200mm	Board	20.32
73765 1230			33mm x 600mm x 1200mm	Board	24.94
98001 0965	Lafarge	Ordinary Portland Cement	25kg	Bag	7.06
98001 1001		Blue Circle Cement	25kg	Bag	12.19
98043 2000	Monafloor	Tranquilt Underscreed	10mm x 20mm x 1.5mm	m ²	10.78
16730 5002	Rockwool	Rockfloor	100mm x 1000mm x 600mm	m ²	33.09
98037 2383	Thermal Economics	Iso Rubberbase 6	6m x 1m x 10m	m ²	9.72

CHIPBOARD

CODE	MANUFACTURER	PRODUCT NAME	DIMENSIONS	£ PRICE (per board)
97870 1180	Speedline	Moisture resistant P5, V313, T & G	18mm x 600mm x 2400mm	9.09
97870 1220		Moisture resistant P5, V313, T & G	22mm x 600mm x 2400mm	11.19
97870 3180		Speedline Safedek with peel off membrane	18mm x 600mm x 2400mm	20.46
97870 3220		Speedline Safedek with peel off membrane	22mm x 600mm x 2400mm	23.87

ACCESSORIES

TEMPORARY SITE PROTECTION

CODE	MANUFACTURER	PRODUCT NAME	THICKNESS	SIZE	WEIGHT (kg)	£ PRICE (per roll)
83523 0030	Britton Merlin	Clear Polythene Sheeting	43mu	4m x 50m	8kg	48.52
83523 0040			65mu	4m x 25m	6kg	36.37
83523 0020			86mu	4m x 25m	8kg	48.52
83523 0100			100mu	4m x 50m	18.4kg	100.28
83523 0125			125mu	4m x 50m	23kg	109.46

CODE	MANUFACTURER	PRODUCT NAME	DESCRIPTION	UNIT	£ PRICE (per unit)
A9466 0005	Ockwells	Easi-peel tape	50mm x 33m white	Rolls	POA
A9466 0020			F/r 50mm x 33m	Rolls	POA
A9532 0005		Temporary screen props	Ockprop blue adj pole 1.15 - 2.9 mtr	No.	POA
A9532 0010			Ockprop orange teles pole 2.1-3.95 mtr	No.	POA
A9538 0005		Zip access doors	Quickprop zip & stick kits	No.	POA
A9572 0100		Polythene film	Tps heavy duty 6kg 4m x 25m	Rolls	POA

FINNFOREST SPRUCE PLYWOOD

CODE	THICKNESS (mm)	WIDTH (mm)	LENGTH (mm)	No. (per pack)	£ PRICE (per sheet)
98073 0010	9	1200	2400	110	15.51
98073 0120	12	1200	2400	85	17.06
98073 0150	15	1200	2400	65	23.55
98073 0180	18	1200	2400	55	24.84











Make your mark with spruce plywood

Finnforest spruce plywood is strong, flat, lightweight and easy to work with. Each panel shows the 'EN636-2S' and 'BS5268-2:2002' mark and complies to EN13986, making it ideal for most flooring, roofing and wall sheathing applications. Available in metric sizes to correspond with plaster boarding and finished with a tongue and groove or square edge.

→ www.finnforest.co.uk for further details

GUIDE TO FIXINGS

A range of high quality fixings

	BZP Drywall Screws: Corrosion resistant self-tapping zinc plated steel screws with cross-heads. Ideal for fixing board to stud up to 0.79mm.
	Coarse Thread Screws: Specifically designed for installation of boards directly onto timber framework. The coarse thread provides excellent drive and grip for quick and easy installation.
	Plugs: Combination of masonry nail and plastic wall fixing for general purpose fixing into brick and concrete.
	Wafer Head Drywall Screws: Self-tapping zinc plated steel screw with wafer head and self-drilling points ideal for metal to metal fixing.
	Wafer Head Jack Point Screws: Zinc plated self tapping steel screws with self-drilling points ideal for metal to metal fixing.
	Collated Drywall Screws: Suitable for use with a wide range of auto feed screw drivers. The collated drywalls allow quick installation of screws into plasterboard.
	Metal Nails-Ins: Suitable applications into concrete and full bricks for fixing brackets, straps and general items.
	Hammerfix Nylon: Applications for use include concrete, brick and hollow concrete blocks.

GUIDE TO FIXINGS - USAGE RATES

THICKNESS (mm)	DRYWALL SCREWS TO FIX PLASTERBOARD FOR DIRECT DECORATIONS		GALVANISED NAILS (MM) TO FIX PLASTERBOARD FOR DIRECT DECORATION AND PLASTERBOARD
	TO METAL SECTIONS	TO TIMBER	
Plasterboard			
9.5	25	32	30
12.5	25	36	40
15	25	36	40
19	32	42	50
12.5 over 12.5	36	50	50
15 over 15	42	60	65
12.5 over 19	42	60	65
Thermal Laminates			
25	36	50	50
30	42	60	
32	42	60	65
35	42	60	65
40	60	65	
45	60	75	75
50	60	75	75
Approx requirements			
Screws		1250/100m2 of board	
Nails	30 and 40mm	5-6kg/100m2 of board	
	50, 65 and 75mm	7-9kg/100m2 of board	

ALUMINIUM TRIMS

GUIDE TO ALUMINIUM TRIMS

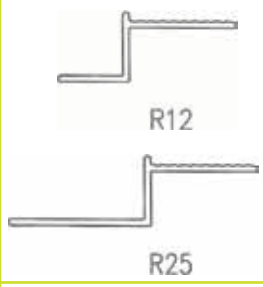
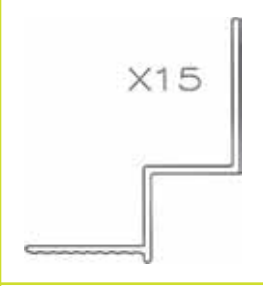
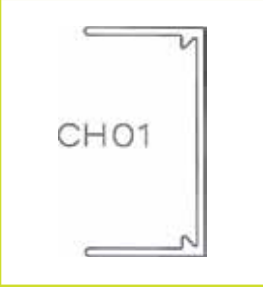
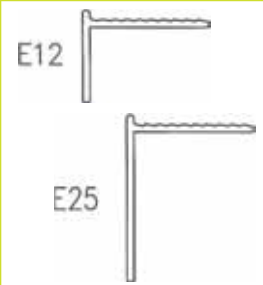
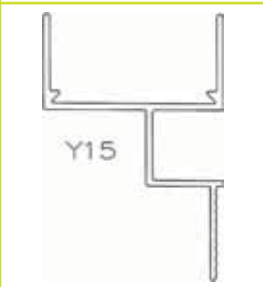
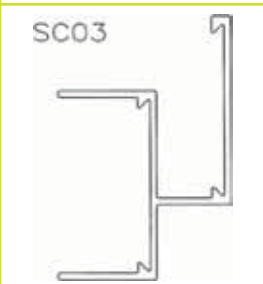
 <p>R12</p> <p>R25</p>	<p>R12 and R25</p> <p>Use - Creates a recessed gap between surfaces, e.g. Skirtings, door reveals & ceiling to wall junctions</p> <p>How to apply – Screw fixed via the fixing flange, through plasterboard, into framework behind. Trims are then finished with a tape & joint application before final decoration.</p>
 <p>X15</p>	<p>X15</p> <p>Use – Used as a suspended ceiling trim for plasterboard soffits. Creates a recessed gap between the wall and ceiling surfaces</p> <p>How to apply – Screw fixed through the solid vertical flange to the wall and also via the fixing flange through plasterboard into framework behind. Trims are then finished with a tape & joint application before final decoration.</p>
 <p>CH01</p>	<p>CH01</p> <p>Use – Used as a suspended ceiling trim for metal ceilings, providing a wedge down facility for cut tiles.</p> <p>How to apply – Screw fixed through the back of the channel into the wall. Ceiling tiles (full or cut) are laid onto the horizontal flange. Cut tiles must be wedged down to retain the correct aesthetics of the finished ceiling. The trim also has a facility to accept both straight and angled cleats for joining.</p>
 <p>E12</p> <p>E25</p>	<p>E12 and E25</p> <p>Use – Creates a stop end to cut plasterboard and can be used in dry lining or ceiling applications</p> <p>How to apply – Screw fix via the fixing flange through plasterboard into framework behind. Trims are then finished with a tape & joint application before final decoration</p>
 <p>Y15</p>	<p>Y15</p> <p>Use – Used as a transition trim between plasterboard and metal tile suspended ceilings creating a recessed gap between the two. The trim has a wedge down facility as with section CH01 for cut metal tiles.</p> <p>How to apply – Screw fix via the fixing flange through plasterboard into the framework behind. The trim must either be independently suspended to take the full weight of the metal tiles and/or braced back to the ceiling framework. The trim also has a facility to accept both straight and angled cleats for joining.</p>
 <p>SC03</p>	<p>SC03</p> <p>Use – Used as a suspended ceiling trim for metal ceilings providing a shadowgap detail against the wall together with a wedge down facility for cut tiles.</p> <p>How to apply – Screw fixed through the back of the vertical leg into the wall. Ceiling tiles (full or cut) are laid onto the horizontal flange. Cut tiles must be wedged down to retain the correct aesthetics of the finished ceiling. The trim also has a facility to accept both straight and angled cleats for joining.</p>

All trims are created from extruded aluminium; power coated to RAL 9010, 30% gloss and are supplied in 3000mm lengths as standard.

Alternative sizes and colours are available on request with bespoke curving facilities for the majority of sections also available

GUIDE TO BEADS & MESH

ANGLE BEADS

Ref. 550/558
(Pre-Galvanised Steel)
Provides a true, straight corner which protects and reinforces plaster where it is most vulnerable. One size adjusts for thickness.



REFERENCE	550	558
For internal use		
T x L (mm)	10/13 x 55	10/13 x 46
Lengths per Carton	50	50
Stock Lengths	2400/2700/3000	2400/2700/3000

PLASTER STOP BEADS

Ref. 562, 563, 565 & 566
(Pre-Galvanised Steel)
Finishes and protects plaster edges

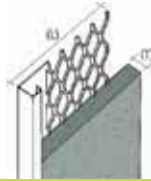

REFERENCE	562	563	565	566
For internal use				
T x L (mm)	10 x 55	10 x 60	16 x 61	19 x 58
Lengths per Carton	50	50	50	50
Stock Lengths	2400/3000	2400/3000	2400/3000	2400/3000

UPVC BEADS

Ref. PTC002
Provides a true, clean corner for plasterboard or any smooth background. Protects and reinforces plasterboard joists to minimise cracking.

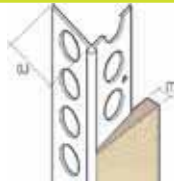

REFERENCE	PTC002
For internal and external use	
Plaster Thickness	3mm
T x L (mm)	3 x 25
Lengths per Carton	25
Bead Lengths	White 2500 Coloured 3000

METAL LATHING

BB263 – Provides a key for lightweight plasters over small openings and chases.
BB264 – Carrier for lightweight plaster finishes on walls and ceilings.
BB265 – General plaster reinforcement.

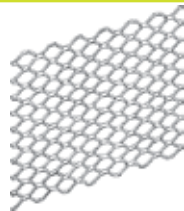

REFERENCE	MATERIAL THICKNESS (mm)	NOMINAL WEIGHT (kg/m ²)	MESH SIZE SW (mm)	MAXIMUM FIXING CENTRE (mm)	SHEET SIZE (mm)
For internal use					
263	0.500	1.11	9	300	2500 x 700
264	0.725	1.61	9	350	2500 x 700
265	0.400	0.90	9	300	2500 x 700

PLASTERBOARD EDGING BEADS

Ref. 567, 568 & 576
(Pre-Galvanised steel)
A reversible, dual-purpose bead which reinforces plasterboard edges by enclosing them in a protective steel section

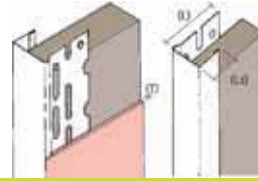

REFERENCE	567	568	576
For internal use			
Plasterboard Thickness	9.5mm	12.5mm	15mm
T x L x L1	2 x 24 x 9	2 x 24 x 12.5	2 x 25.5 x 10
Lengths per Carton	50	50	50
Stock Lengths	3000	3000	3000

THIN COAT ANGLE BEADS

Ref. 553
(Pre-Galvanised steel)
For 3mm plaster finishes on plasterboard or any smooth background

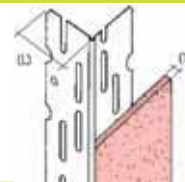

REFERENCE	553
For internal use	
T x L (mm)	3 x 24
Lengths per Carton	50
Stock Lengths	2400/2700/3000

THIN COAT STOP BEADS

Ref. 560 & 561
(Pre-Galvanised steel)
Finishes and reinforces edges of thin-coat plaster

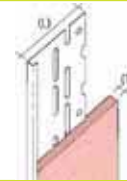

REFERENCE	560	561
For internal use		
T x L (mm)	3 x 28	6 x 25
Lengths per Carton	50	50
Stock Lengths	2400/3000	2400/3000

METAL LATHING

Riblath
267 – Stainless steel carrier for render finishes.

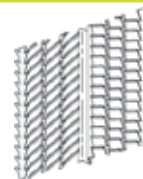

REFERENCE	MATERIAL THICKNESS (mm)	NOMINAL WEIGHT (kg/m ²)	RIB DEPTH (mm)	MAXIMUM CENTRES OF SUPPORT (mm)	SHEET SIZE (mm)
For external use					
267	0.3	1.16	8	600	2500 x 600

955
955 – Stainless steel carrier for render finishes.

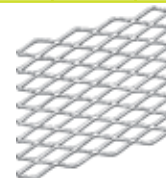

REFERENCE	MATERIAL THICKNESS (mm)	NOMINAL WEIGHT (kg/m ²)	MESH SIZE SW & LW (mm)	MAXIMUM FIXING CENTRES (mm)	SHEET SIZE (mm)
For external use					
955	0.460	1.15	9.2 x 28.6	350	2500 x 700